

- LEGEND**
- GENERAL:-**
- RP boundary.
  - Top of batter.
  - Toe of batter.
  - Stormwater invert drain line.
  - Subsoil drain.
  - Sewer main.
  - Sewer manhole.
  - Water main.
  - Poly water main.
  - Stormwater drain line.
  - Sewer main.
  - Sewer manhole.
  - Water main.
  - Poly water main.
  - Fence line.
  - Crusher dust / sodic soil backfill.
- SEWERAGE RETICULATION:-**
- 2 - Manhole Number
  - 1A - Sewer line description
  - 2.000\* 1.950\* - Sewer invert levels at manhole.
  - 1A - Sewer line description.
  - 150Ø uPVC Class SN10 - Diameter of pipe.
  - 28.500m\* at 1:108.4\* - Distance between manholes, centreline to centreline and grade.
  - TM 14.550\* - Top of manhole level.
- SERVICES:-**
- Direct connection (DC)
  - Jump up connection (JU)
  - Riser connection (RC)
  - 100Ø manhole connection - Benching (BC) - Vertical Drop (VD)
- Distance from downstream manhole to Y-junction - dimension 'L'.  
 Invert level at limit of house connection branch.  
 Allotment connection dimension 'X'.  
 Allotment connection dimension 'Y'.  
 Type of junction (EX - Existing).  
 Level at top of riser cap.

**AS CONSTRUCTED**

BRAZIER & MOTTI PTY.LTD. (ACN 066 411 041), 595 FLINDERS STREET, TOWNVILLE HEREBY CERTIFY THAT THIS DRAWING ACCURATELY AND CORRECTLY DESCRIBES AND RECORDS THE NATURE AND THE LOCATION OF THE WORKS DEPICTED BY ASTERISKS (\*) HEREON AS THEY HAVE BEEN CONSTRUCTED FOR SUBDIVISION

REGISTERED SURVEYOR AND DIRECTOR

DATED THIS DAY 15 OF JULY 2012

- NOTES:**
- All sewer manholes are 1050Ø type C2 U.N.O.
  - All sewer manhole tops are type 2 class 'B' covers U.N.O.
  - All 150Ø sewer mains & fittings are uPVC class SN10.
  - All 100Ø sewer mains & fittings are uPVC class SN10.

**SEWER MANHOLES**

Manhole No.	Easting	Northing
1/WD2E	5579.182*	71267.293*
2/WD2E	5568.512*	71245.769*
3/WD2E	5542.502*	71257.813*
4/WD2E	5525.331*	71221.707*
5/WD2E	5499.306*	71166.627*
6/WD2E	5465.543*	71094.715*
7/WD2E	5454.689*	71072.428*
1/WD2E1	5481.144*	71242.339*
2/WD2E1	5469.965*	71219.209*
3/WD2E1	5430.842*	71136.423*
4/WD2E1	5421.669*	71117.184*
1/WD2E2	5420.814*	71228.030*
2/WD2E2	5405.290*	71230.814*
1/WD2E3	5401.719*	71150.227*

- All dimensions are to centre of chamber.

**REAL PROPERTY DESCRIPTION**

Lot 2 on SP 232875  
 Parish of BOHLE  
 County of ELPHINSTONE  
 Geaney Lane - Deeragun

In Association with:-

surveying | town planning | project management | mapping and GIS

Brazier Motti Pty Ltd (ACN 066 411 041)  
 595 Flinders St, Townsville, Q. 4810  
 Phone: 07 4772 1144, Fax: 07 4772 2557, Email: townsville@braziermotti.com.au

**LAYOUT PLAN**

**ACCEPTED AS CONSTRUCTED**

# - Indicates calculated 'Y' junction level (200mm above sewer main invert)  
 \* - Indicates as constructed information.

All work is to be carried out in accordance with LOCAL AUTHORITIES standard details.

**NORTHERN CONSULTING**  
 engineers

Civil & Structural Engineers  
 50 Punari Street, Currajong 4812  
 Phone: 07 4725 5550 Fax: 07 4725 5850  
 Email: mail@nceng.com.au  
 Milton Mossor & Associates Pty. Ltd.  
 ACN 100 817 356

Scale  
 0 5 10 15 20m

THE ORIGINAL OF THIS DOCUMENT IS COMPLETED TO THE SCALE NOTED. AS REPRODUCTION CAN DISTORT SIZE & SHAPE USE ONLY THE DIMENSIONS PROVIDED ON ARCHITECTURAL &/OR ENGINEERING DRAWINGS. VERIFY DIMENSIONS ON SITE BEFORE CONSTRUCTION.

Issue	Description	Date
C	AS CONSTRUCTED - BW2A (22 LOTS) REVISION B	05/07/2012
B	ISSUED FOR CONSTRUCTION - BW2A (22 LOTS) REVISION A	21/06/2012
A	ISSUED FOR CONSTRUCTION - BW2A (22 LOTS) REVISION A	13/10/2011
P3	PRELIMINARY - NOT FOR CONSTRUCTION - AMENDED TO COUNCIL R.O.L. NOTICE - ISSUED FOR COUNCIL APPROVAL (OPW).	23/08/2011
P2	PRELIMINARY - NOT FOR CONSTRUCTION - ISSUED FOR COUNCIL APPROVAL (OPW).	21/07/2011
P1	PRELIMINARY - NOT FOR CONSTRUCTION - ISSUED FOR COUNCIL APPROVAL (OPW).	11/07/2011

Drawn	In Association With	SEWERAGE RETICULATION PLAN
JHS	<b>PARKSIDE DEVELOPMENT</b>	
11/07/2011	<b>PTY LTD</b>	
Checked	<b>STAGE 2, 31 ALLOTMENT</b>	
Approved	<b>RESIDENTIAL SUBDIVISION</b>	
	<b>BRENDALE WEST</b>	
	<b>GOTHAM LOOP, DEERAGUN</b>	

Drawing Number	Issue
<b>PARK0002/13</b>	<b>C</b>

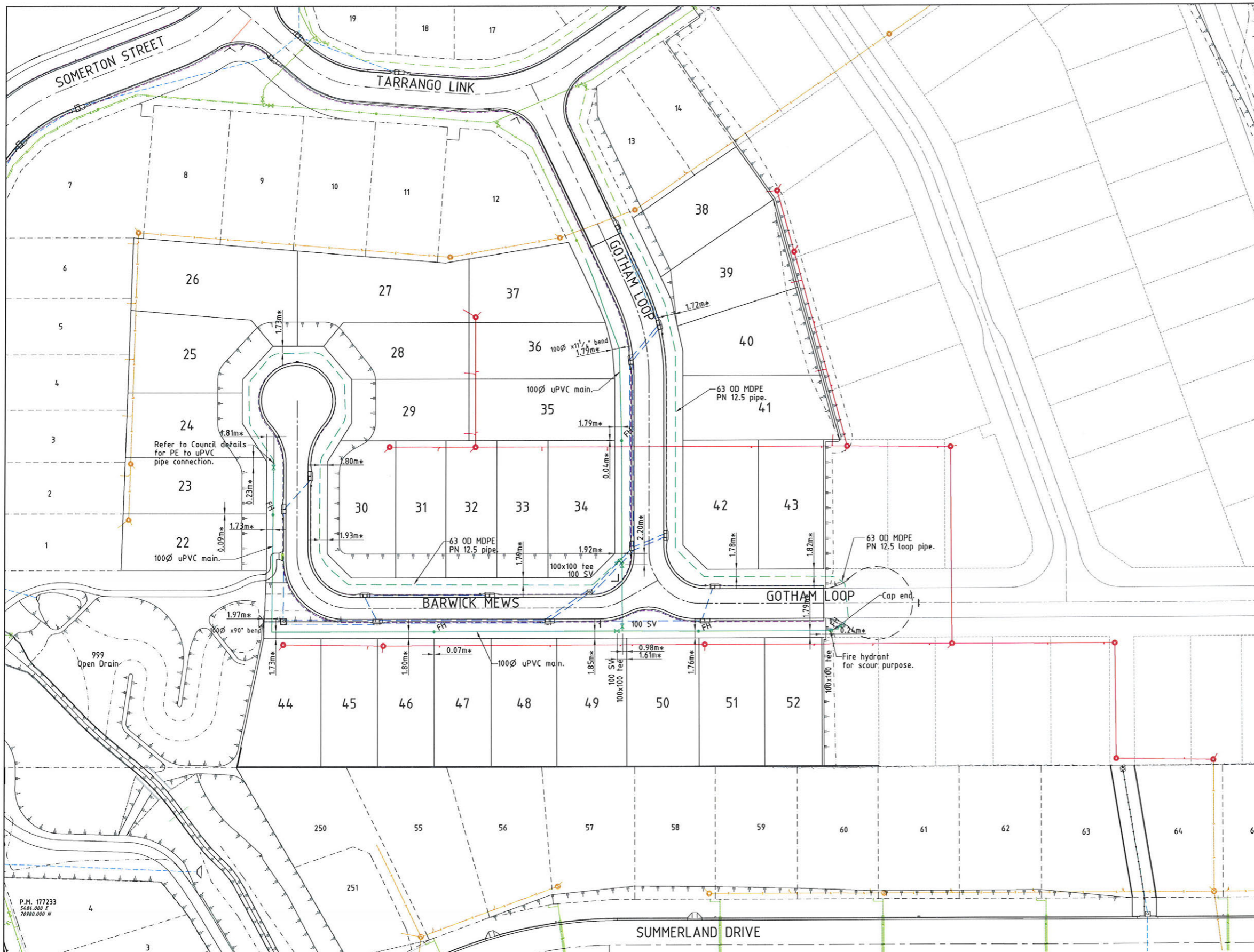

- LEGEND**  
GENERAL:-
- RP boundary.
  - Top of batter.
  - Toe of batter.
  - Stormwater invert drain line.
  - Subsoil drain.
  - Sewer main.
  - Sewer manhole.
  - Water main.
  - Poly water main.
  - Stormwater drain line.
  - Sewer main.
  - Sewer manhole.
  - Water main.
  - Poly water main.
  - Fence line.

- WATER RETICULATION:-**
- FH Fire Hydrant.
  - SV Stop Valve.

- NOTES:**  
**AS CONSTRUCTED WATER RETICULATION:**
- All water supply fixtures (FH, SV etc.) have been installed in accordance with Townsville City Council standards, ie. adjacent to boundary intersection, U.N.O.
  - All uPVC water mains & fittings are Class 16 cast iron outside diameter compatible unless shown otherwise.

**AS CONSTRUCTED**  
BRAZIER & MOTTI PTY.LTD. (ACN 066 411 041), 595 FLINDERS STREET, TOWNVILLE HEREBY CERTIFY THAT THIS DRAWING ACCURATELY AND CORRECTLY DESCRIBES AND RECORDS THE NATURE AND THE LOCATION OF THE WORKS DEPICTED BY ASTERISKS (\*) HEREON AS THEY HAVE BEEN CONSTRUCTED FOR SUBDIVISION

\_\_\_\_\_  
DIRECTOR  
REGISTERED SURVEYOR AND DIRECTOR  
DATED THIS DAY 5 OF July 2012

SEAL OF  
ACN 066 411 041

**REAL PROPERTY DESCRIPTION**  
Lot 2 on SP 232875  
Parish of BOHLE  
County of ELPHINSTONE  
Geaney Lane - Deeragun

In Association with:-  
**brazier motti**  
surveying | town planning | project management | mapping and GIS  
Brazier Motti Pty Ltd (ACN 066 411 041)  
595 Flinders St, Townsville, Q, 4810  
Phone: 07 4772 1144, Fax: 07 4772 2557, Email: townsville@braziermotti.com.au

**LAYOUT PLAN**

**ACCEPTED AS CONSTRUCTED**

\* - Indicates as constructed information.

All work is to be carried out in accordance with LOCAL AUTHORITIES standard details.

**NORTHERN CONSULTING engineers**  
Civil & Structural Engineers  
50 Punari Street, Currajong 4812  
Phone: 07 4725 5550 Fax: 07 4725 5850  
Email: mail@nceng.com.au  
Milton Messer & Associates Pty. Ltd.  
ACN 100 817 358

**Scale**  
0 5 10 15 20m  
THE ORIGINAL OF THIS DOCUMENT IS COMPLETED TO THE SCALE NOTED. AS REPRODUCTION CAN DISTORT SIZE & SHAPE USE ONLY THE DIMENSIONS PROVIDED ON ARCHITECTURAL &/OR ENGINEERING DRAWINGS. VERIFY DIMENSIONS ON SITE BEFORE CONSTRUCTION.

**BASE SURVEY**  
Brazier Motti (06092/091)  
TRUNCATED COORDINATES  
E 0.000, N 0.000  
EQUIVALENT TO  
E 4.60000, N 7800000

**LEVEL DATUM A.H.D.**  
Horizontal Datum GDA' 94 Zone 55  
Refer P.M. 177233 RL. 13.514  
Bull & washer in kerb.  
Intersection SOMERTON/DUNDABELLA

Issue	Description	Date
E	AS CONSTRUCTED - BW2A (22 LOTS) REVISION B	05/07/2012
D	PRELIMINARY - AS CONSTRUCTED - BW2A (22 LOTS) REVISION A	21/06/2012
C	SERVICE CONNECTIONS & PATHWAY REMOVED FROM LOTS 44-52.	17/01/2012
B	WATER MAIN AMENDED TO 1.8M ALIGNMENT & SERVICE CONNECTION ADDED TO LOTS 44-52.	10/01/2012
A	ISSUED FOR CONSTRUCTION.	08/12/2011
P2	PRELIMINARY - NOT FOR CONSTRUCTION - AMENDED TO COUNCIL R.O.L. NOTICE - ISSUED FOR COUNCIL APPROVAL (OPW).	23/08/2011
P1	PRELIMINARY - NOT FOR CONSTRUCTION - ISSUED FOR COUNCIL APPROVAL (OPW).	11/07/2011

Drawn JHS	In Association With <b>PARKSIDE DEVELOPMENT PTY LTD</b>	<b>WATER RETICULATION PLAN</b>
Date 11/07/2011	<b>STAGE 2, 31 ALLOTMENT RESIDENTIAL SUBDIVISION BRENDALE WEST GOTHAM LOOP, DEERAGUN</b>	
Checked [Signature]		Drawing Number <b>PARK0002/14</b>
Approved [Signature]		Issue <b>E</b>

COPYRIGHT ©