

- LEGEND**
- 12.000* - As constructed surface levels.
 - 12.000 - Surface levels.
 - 1% AEP 12.00 - 1% AEP water surface levels.
 - - Stormwater flow arrow.
 - - - - - RP boundary.
 - - - - - Change in grade.
 - - - - - Sewer main.
 - - - - - Sewer manhole.
 - - - - - uPVC water main.
 - - - - - Poly water main.
 - - - - - Stormwater drain line.
 - - - - - Sewer main.
 - - - - - Sewer manhole.
 - - - - - Water main.
 - - - - - Poly water main.

NOTES:

- All approved fill material has been placed, compacted & tested in accordance with AS 3798 'Guidelines on Earthworks for Commercial & Residential Developments'.

ACCEPTED AS CONSTRUCTED

AS CONSTRUCTED
 Rowlands Surveys Pty Ltd (ACN 010 025 260) hereby certify that the works detailed on this drawing, denoted *, have been constructed to the dimensions and levels shown.

Laurence John Nolan
 Director/Registered Surveyor
 Date: 09/03/2018

AS CONSTRUCTED
 I, Andrew Ian Wallace of Northern Consulting Engineers hereby certify that the works as shown on the as constructed drawings reflect any changes that were made during the course of construction.

Andrew Ian Wallace
 Andrew Ian Wallace - (RPEQ No. 6743)
 Date: 26/03/2018



REAL PROPERTY DESCRIPTION
 Lot 900 on SP278572
 Parish of BOHLE
 County of ELPHINSTONE
 Conway Street - Mount Low

LEVEL DATUM A.H.D. (Der)
 Horizontal Datum GDA' 94 Zone 55
 Refer PM 19351B RL. 8.195
 Bolt and washer in kerb
 FREMONT STREET.

Scale
 0 2.5 5 7.5 10m
 THE ORIGINAL OF THIS DOCUMENT IS COMPLETED TO THE SCALE NOTED.
 AS REPRODUCTION CAN DISTORT SIZE & SHAPE USE ONLY THE DIMENSIONS PROVIDED ON ARCHITECTURAL &/OR ENGINEERING DRAWINGS.
 VERIFY DIMENSIONS ON SITE BEFORE CONSTRUCTION.

All work carried out in accordance with LOCAL AUTHORITIES standard details.



Civil & Structural Engineers
 50 Punari Street, Currajong 4812
 Phone: [07] 4725 5550 Fax: [07] 4725 5850
 Email: mail@nceng.com.au
 Milton Messer & Associates Pty. Ltd.
 ACN 100 817 356

B A P1	AMENDED TO AS CONSTRUCTED. ISSUED FOR CONSTRUCTION. PRELIMINARY - NOT FOR CONSTRUCTION - ISSUED FOR OPERATIONAL WORKS APPROVAL.	06/03/2018 27/03/2017 14/12/2016
Issue	Description	Date
Drawn KJM Date 14/12/2016	In Association With BUSHLAND GROVE PTY LTD	CUT/FILL LAYOUT PLAN
Checked HAB Approved	BUSHLAND GROVE ESTATE STAGE 15, 18 ALLOTMENT RESIDENTIAL SUBDIVISION, MOUNT LOW	
COPYRIGHT ©	Drawing Number TUR0815/4	Issue B

**ACCEPTED
AS CONSTRUCTED**

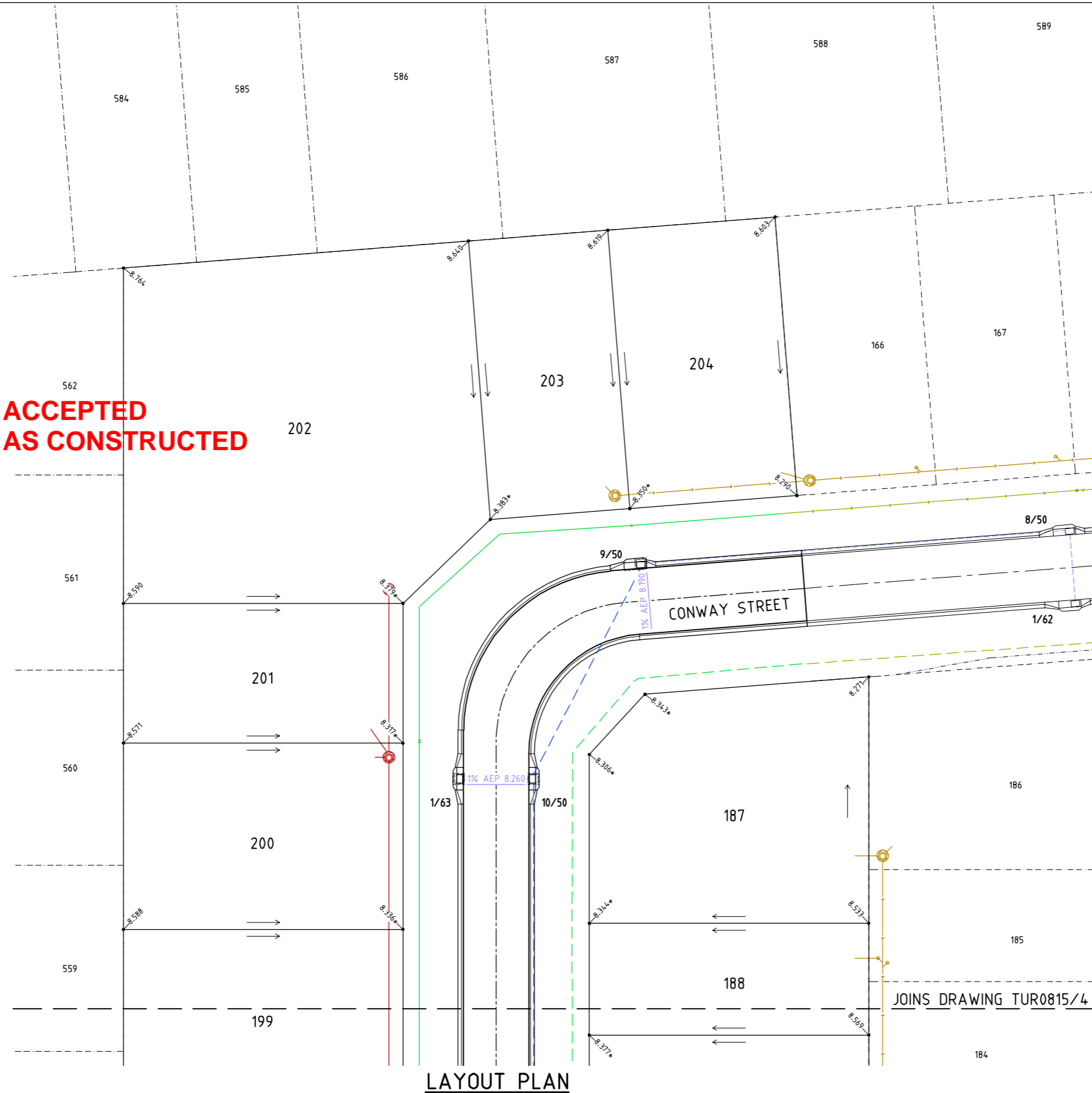

LAYOUT PLAN

- LEGEND**
- 12.000* - As constructed surface levels.
 - 12.000 - Surface levels.
 - 1% AEP 12.00 - 1% AEP water surface levels.
 - - Stormwater flow arrow.
 - - - - - RP boundary.
 - - - - - Sewer main.
 - - Sewer manhole.
 - - - - - uPVC water main.
 - - - - - Poly water main.
 - - - - - Stormwater drain line.
 - - - - - Stormwater drain line.
 - - - - - Sewer main.
 - - Sewer manhole.
 - - - - - Water main.
 - - - - - Poly water main.

NOTES:

- All approved fill material has been placed, compacted & tested in accordance with AS 3798 'Guidelines on Earthworks for Commercial & Residential Developments'.

AS CONSTRUCTED
 Rowlands Surveys Pty Ltd (ACN 010 025 260) hereby certify that the works detailed on this drawing, denoted *, have been constructed to the dimensions and levels shown.

Laurence John Nolan
 Director/Registered Surveyor

Date: 09/03/2018

AS CONSTRUCTED
 I, Andrew Ian Wallace of Northern Consulting Engineers hereby certify that the works as shown on the as constructed drawings reflect any changes that were made during the course of construction.

Andrew Ian Wallace
 Andrew Ian Wallace - (RPEQ No. 6743)

Date: 26/03/2018

**PLANNING AND
COMMUNITY
ENGAGEMENT**

City of Townsville

RECEIVED: 27/03/2018

All work carried out in accordance with LOCAL AUTHORITIES standard details.

REAL PROPERTY DESCRIPTION
 Lot 900 on SP278572
 Parish of BOHLE
 County of ELPHINSTONE
 Conway Street - Mount Low

LEVEL DATUM A.H.D. (Der)
 Horizontal Datum GDA' 94 Zone 55
 Refer PM 19351B RL. 8.195
 Bolt and washer in kerb
 FREMONT STREET.

Scale
 0 2.5 5 7.5 10m

THE ORIGINAL OF THIS DOCUMENT IS COMPLETED TO THE SCALE NOTED. AS REPRODUCTION CAN DISTORT SIZE & SHAPE USE ONLY THE DIMENSIONS PROVIDED ON ARCHITECTURAL &/OR ENGINEERING DRAWINGS. VERIFY DIMENSIONS ON SITE BEFORE CONSTRUCTION.

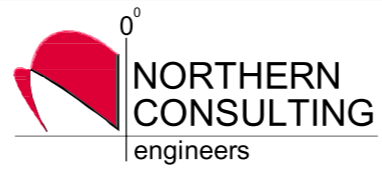

Civil & Structural Engineers
 50 Punari Street, Currajong 4812
 Phone: [07] 4725 5550 Fax: [07] 4725 5850
 Email: mail@nceng.com.au
 Milton Messer & Associates Pty. Ltd.
 ACN 100 817 356

B	AMENDED TO AS CONSTRUCTED.	06/03/2018
A	ISSUED FOR CONSTRUCTION.	27/03/2017
P1	PRELIMINARY - NOT FOR CONSTRUCTION - ISSUED FOR OPERATIONAL WORKS APPROVAL.	14/12/2016
Issue	Description	Date
Drawn KJM Date 14/12/2016	In Association With BUSHLAND GROVE PTY LTD	CUT/FILL LAYOUT PLAN
Checked HAB Approved	BUSHLAND GROVE ESTATE STAGE 15, 18 ALLOTMENT RESIDENTIAL SUBDIVISION, MOUNT LOW	
COPYRIGHT ©		Drawing Number TUR0815/5
		Issue B



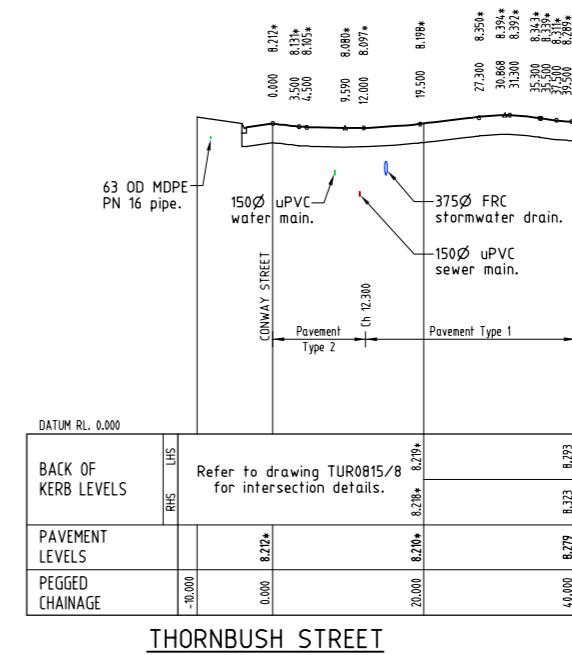
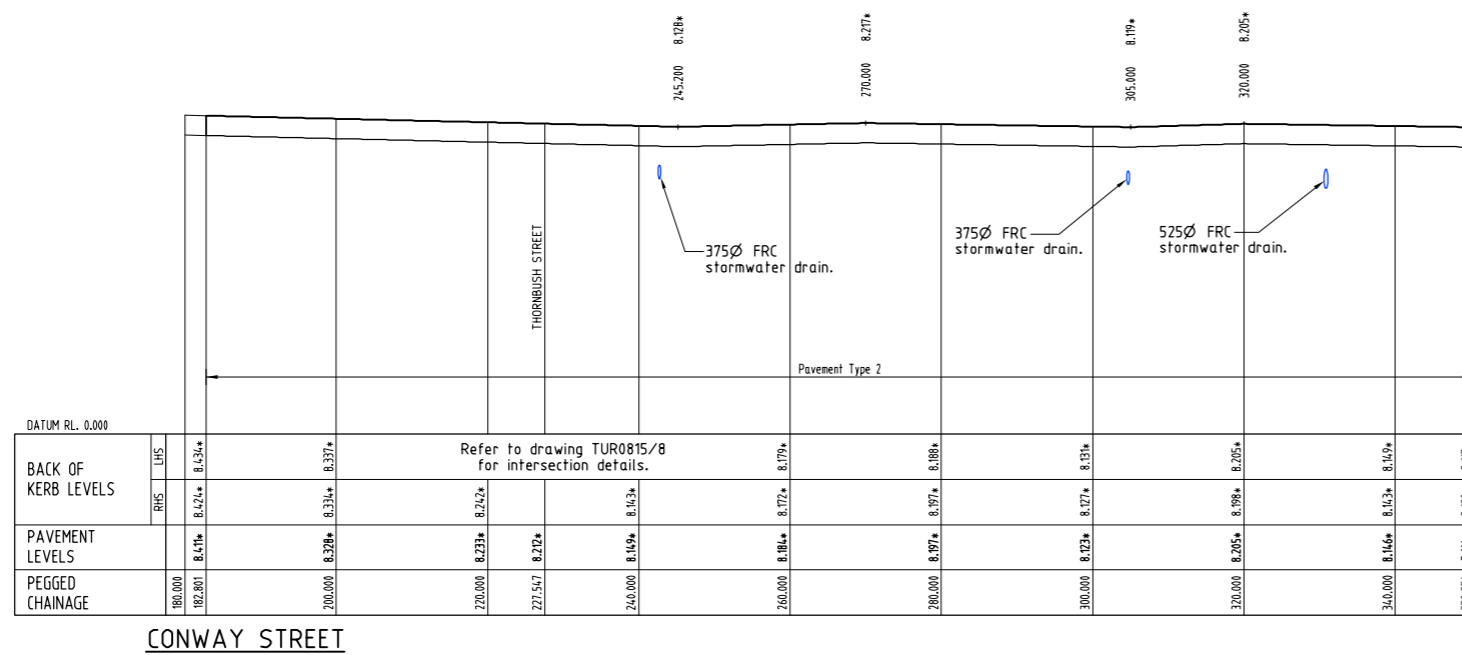

LONGITUDINAL SECTIONS

Scale 'A' - Horizontal
Scale 'B' - Vertical

PAVEMENT TABLE

PAVEMENT TYPE	PAVEMENT DESCRIPTION
Type 1	30mm AC10M Asphalt. Prime 125mm cement modified base course, DTMR Type 2.1, 28 day UCS = 0.7-1.0 MPa 100mm cement modified sub-base course, DTMR Type 2.3, 28 day UCS = 0.7-1.0 MPa 250mm insitu lime stabilised subgrade, 3.1% quicklime, spread rate = 15kg/m ²
Type 2	30mm AC10M Asphalt. Prime 135mm cement modified base course, DTMR Type 2.1, 28 day UCS = 0.7-1.0 MPa 130mm cement modified sub-base course, DTMR Type 2.3, 28 day UCS = 0.7-1.0 MPa 250mm insitu lime stabilised subgrade, 3.1% quicklime, spread rate = 15kg/m ²

**ACCEPTED
AS CONSTRUCTED**

AS CONSTRUCTED

Rowlands Surveys Pty Ltd (ACN 010 025 260) hereby certify that the works detailed on this drawing, denoted *, have been constructed to the dimensions and levels shown.

[Signature]
Laurence John Nolan
Director/Registered Surveyor
Date: 09/03/2018

AS CONSTRUCTED

I, Andrew Ian Wallace of Northern Consulting Engineers hereby certify that the works as shown on the as constructed drawings reflect any changes that were made during the course of construction.

[Signature]
Andrew Ian Wallace - (RPEQ No. 6743)
Date: 26/03/2018



REAL PROPERTY DESCRIPTION
Lot 900 on SP278572
Parish of BÖHLE
County of ELPHINSTONE
Conway Street - Mount Low

LEVEL DATUM A.H.D. (Der)
Horizontal Datum GDA' 94 Zone 55
Refer PM 19351B RL. 8.195
Bolt and washer in kerb
FREMONT STREET.

Scale 'A' 0 5 10 15 20m
Scale 'B' 0 1 2 3 4m
THE ORIGINAL OF THIS DOCUMENT IS COMPLETED TO THE SCALE NOTED.
AS REPRODUCTION CAN DISTORT SIZE & SHAPE USE ONLY THE DIMENSIONS PROVIDED ON ARCHITECTURAL &/OR ENGINEERING DRAWINGS.
VERIFY DIMENSIONS ON SITE BEFORE CONSTRUCTION.

All work carried out in accordance with LOCAL AUTHORITIES standard details.

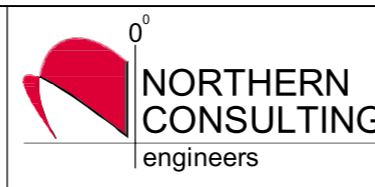

Civil & Structural Engineers
50 Punari Street, Currajong 4812
Phone: [07] 4725 5550 Fax: [07] 4725 5850
Email: mail@nceng.com.au
Milton Messer & Associates Pty. Ltd.
ACN 100 817 356

REFER TO DRAWING TUR0814/7 FOR ROAD TYPICAL SECTIONS.

Issue	Description	Date
B	AMENDED TO AS CONSTRUCTED.	06/03/2018
A	ISSUED FOR CONSTRUCTION.	27/03/2017
P1	PRELIMINARY - NOT FOR CONSTRUCTION - ISSUED FOR OPERATIONAL WORKS APPROVAL.	14/12/2016

Drawn KJM Date 14/12/2016	In Association With BUSHLAND GROVE PTY LTD	ROAD LONGITUDINAL SECTIONS
Checked HAB Approved	BUSHLAND GROVE ESTATE STAGE 15, 18 ALLOTMENT RESIDENTIAL SUBDIVISION, MOUNT LOW	
COPYRIGHT ©		Drawing Number TUR0815/6
		Issue B

AS CONSTRUCTED

Rowlands Surveys Pty Ltd (ACN 010 025 260) hereby certify that the works detailed on this drawing, denoted *, have been constructed to the dimensions and levels shown.

Laurence John Nolan
 Director/Registered Surveyor

Date: 09/03/2018

AS CONSTRUCTED

I, Andrew Ian Wallace of Northern Consulting Engineers hereby certify that the works as shown on the as constructed drawings reflect any changes that were made during the course of construction.

Andrew Ian Wallace
 Andrew Ian Wallace - (RPEQ No. 6743)

Date: 26/03/2018

**ACCEPTED
 AS CONSTRUCTED**

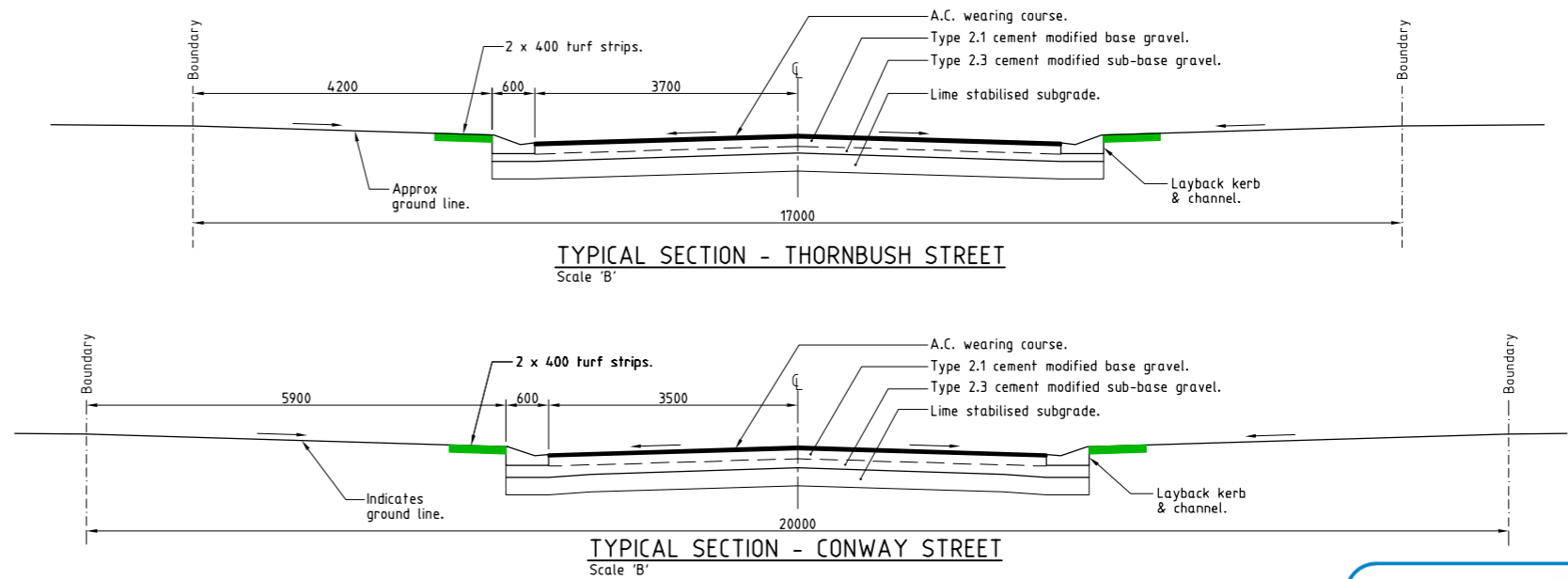
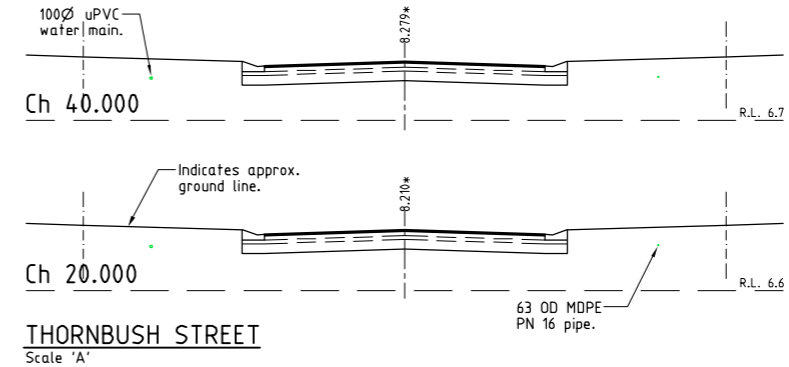
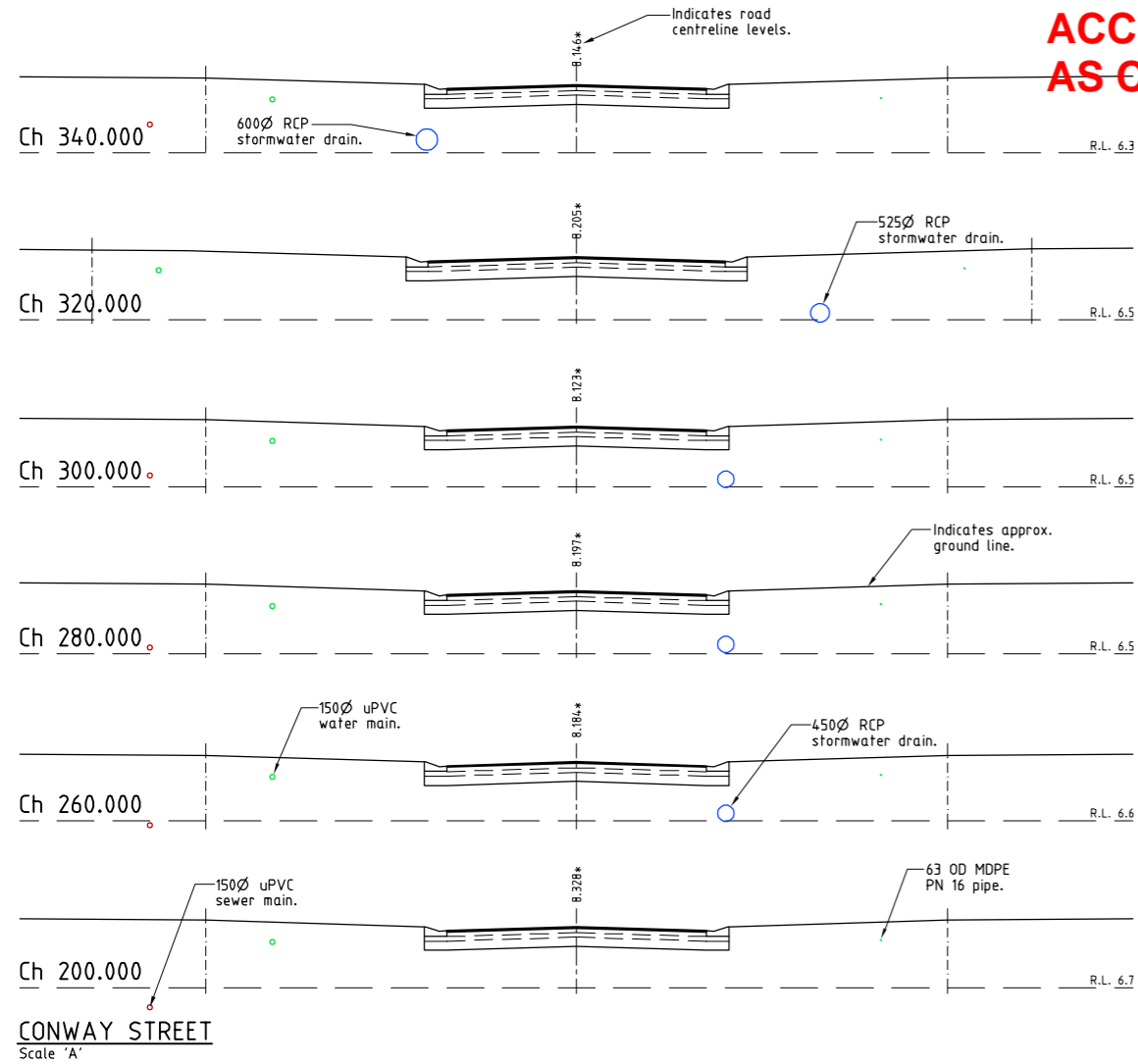

**PLANNING AND
 COMMUNITY
 ENGAGEMENT**

RECEIVED: 27/03/2018

REAL PROPERTY DESCRIPTION
 Lot 900 on SP278572
 Parish of BÖHLE
 County of ELPHINSTONE
 Conway Street - Mount Low

LEVEL DATUM A.H.D. (Der)
 Horizontal Datum GDA' 94 Zone 55
 Refer PM 19351B RL. 8.195
 Bolt and washer in kerb
 FREMONT STREET.

Scale 'A' 0 1 2 3 4m
 Scale 'B' 0 500 1000 1500 2000mm

THE ORIGINAL OF THIS DOCUMENT IS COMPLETED TO THE SCALE NOTED.
 AS REPRODUCTION CAN DISTORT SIZE & SHAPE USE ONLY THE
 DIMENSIONS PROVIDED ON ARCHITECTURAL &/OR ENGINEERING DRAWINGS.
 VERIFY DIMENSIONS ON SITE BEFORE CONSTRUCTION.

All work carried out in accordance with LOCAL AUTHORITIES standard details.



Civil & Structural Engineers
 50 Punari Street, Currajong 4812
 Phone: [07] 4725 5550 Fax: [07] 4725 5850
 Email: mail@nceng.com.au
 Milton Messer & Associates Pty. Ltd.
 ACN 100 817 356

B	AMENDED TO AS CONSTRUCTED.	06/03/2018
A	ISSUED FOR CONSTRUCTION.	27/03/2017
P1	PRELIMINARY - NOT FOR CONSTRUCTION - ISSUED FOR OPERATIONAL WORKS APPROVAL.	14/12/2016
Issue	Description	Date
Drawn KJM Date 14/12/2016	In Association With BUSHLAND GROVE PTY LTD	ROAD TYPICAL SECTIONS & ROAD CROSS SECTIONS
Checked HAB Approved	BUSHLAND GROVE ESTATE STAGE 15, 18 ALLOTMENT RESIDENTIAL SUBDIVISION, MOUNT LOW	
COPYRIGHT ©		Drawing Number TUR0815/7
		Issue B

**ACCEPTED
AS CONSTRUCTED**

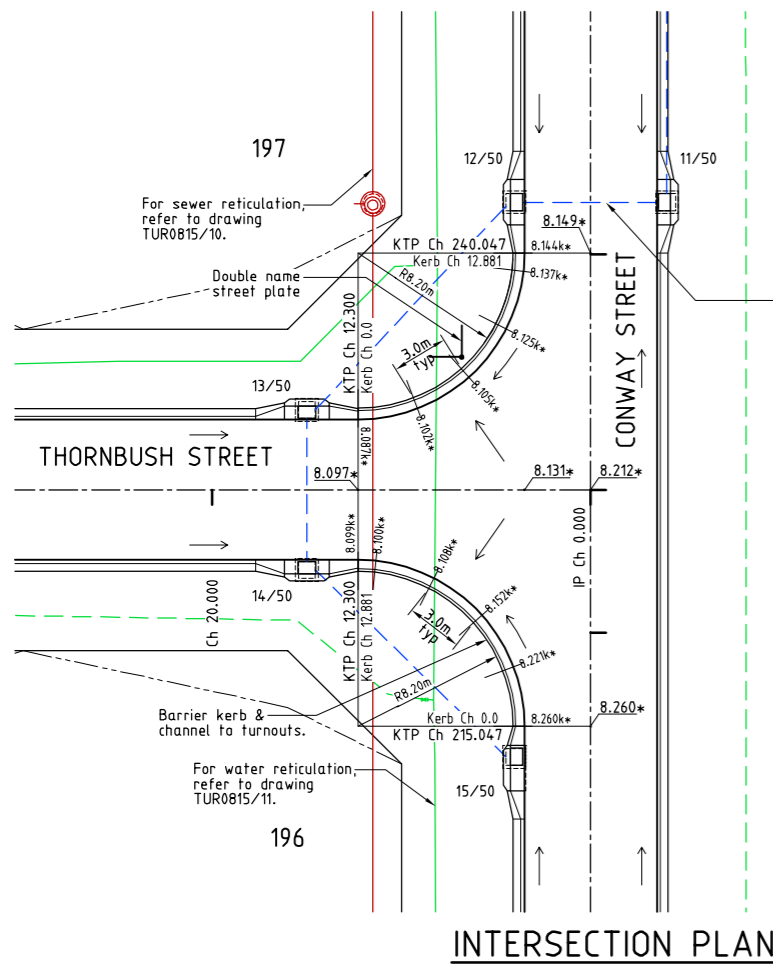

INTERSECTION PLAN

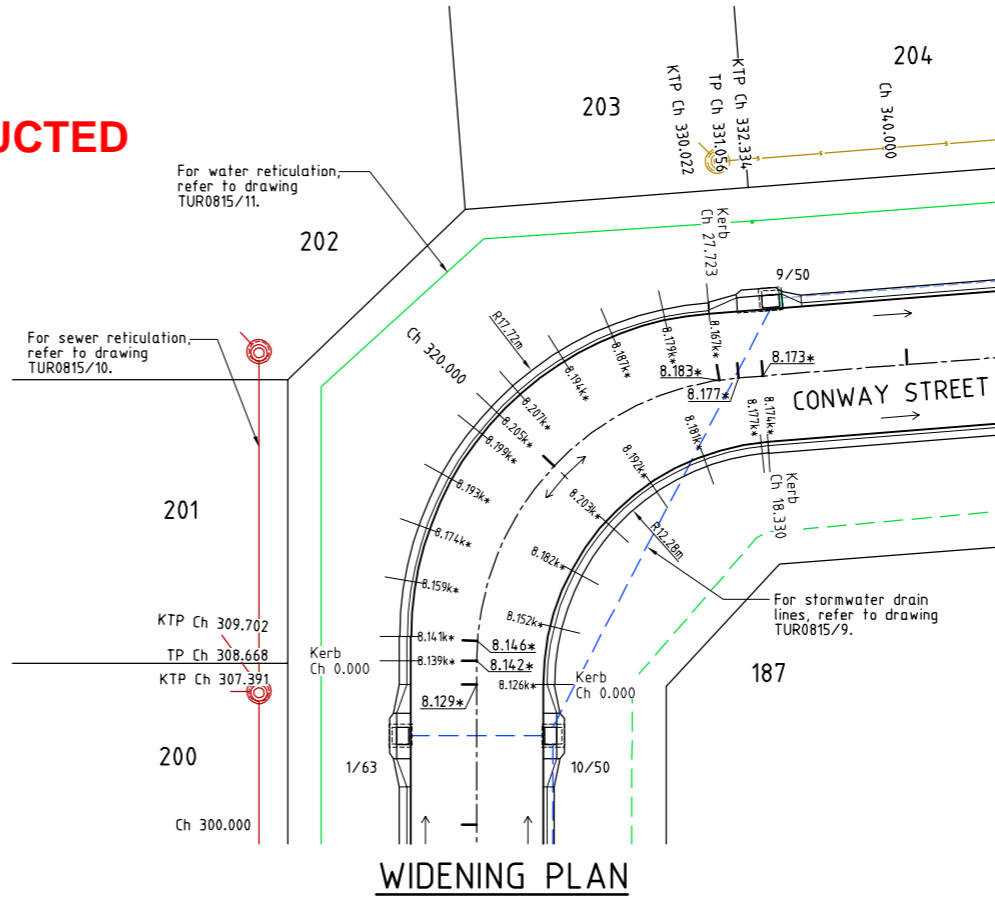

WIDENING PLAN

LEGEND

- 12.000k* - As constructed back of kerb level.
- 12.000* - As constructed pavement level.
- - Stormwater flow arrow.
- - - - - Change in grade.
- (green) — uPVC water main.
- (blue) — Poly water main.
- (dashed blue) — Stormwater drain line.
- (red) — Sewer main.
- ⊙ (red) — Sewer manhole.
- ⊙ (yellow) — Sewer manhole.
- ⊙ (blue) — Sewer manhole.
- (dashed blue) — Stormwater drain line.

AS CONSTRUCTED

Rowlands Surveys Pty Ltd (ACN 010 025 260) hereby certify that the works detailed on this drawing, denoted *, have been constructed to the dimensions and levels shown.

Laurence John Nolan
Director/Registered Surveyor
Date: 09/03/2018

AS CONSTRUCTED

I, Andrew Ian Wallace of Northern Consulting Engineers hereby certify that the works as shown on the as constructed drawings reflect any changes that were made during the course of construction.

Andrew Ian Wallace
Andrew Ian Wallace - (RPED No. 6743)
Date: 26/03/2018



REAL PROPERTY DESCRIPTION
Lot 900 on SP278572
Parish of BOHLE
County of ELPHINSTONE
Conway Street - Mount Low

LEVEL DATUM A.H.D. (Der)
Horizontal Datum GDA' 94 Zone 55
Refer PM 19351B RL. 8.195
Bolt and washer in kerb
FREMONT STREET.



THE ORIGINAL OF THIS DOCUMENT IS COMPLETED TO THE SCALE NOTED.
AS REPRODUCTION CAN DISTORT SIZE & SHAPE USE ONLY THE
DIMENSIONS PROVIDED ON ARCHITECTURAL &/OR ENGINEERING DRAWINGS.
VERIFY DIMENSIONS ON SITE BEFORE CONSTRUCTION.

All work carried out in accordance with LOCAL AUTHORITIES standard details.

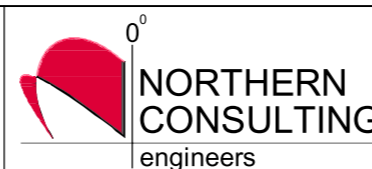

Civil & Structural Engineers
50 Punari Street, Currajong 4812
Phone: [07] 4725 5550 Fax: [07] 4725 5850
Email: mail@nceng.com.au
Milton Messer & Associates Pty. Ltd.
ACN 100 817 356

Issue	Description	Date
B	AMENDED TO AS CONSTRUCTED.	06/03/2018
A	ISSUED FOR CONSTRUCTION.	27/03/2017
P1	PRELIMINARY - NOT FOR CONSTRUCTION - ISSUED FOR OPERATIONAL WORKS APPROVAL.	14/12/2016

Drawn KJM Date 14/12/2016	In Association With BUSHLAND GROVE PTY LTD	INTERSECTION & WIDENING PLAN
Checked HAB Approved	BUSHLAND GROVE ESTATE STAGE 15, 18 ALLOTMENT RESIDENTIAL SUBDIVISION, MOUNT LOW	
COPYRIGHT ©		Drawing Number TUR0815/8
		Issue B