

- LEGEND**
- 2/1 → Pit No. 2/Drainline No. 1
 - Stormwater flow arrow.
 - - - - - RP boundary.
 - - - - - Top of batter.
 - - - - - Toe of batter.
 - - - - - Change of grade.
 - - - - - Sewer main.
 - - - - - Sewer manhole.
 - - - - - uPVC water main.
 - - - - - Poly water main.
 - - - - - Stormwater drain line.
 - - - - - Subsoil drainage.
 - - - - - Irrigation conduit.
 - - - - - Stormwater drain line.
 - - - - - Subsoil drainage.
 - - - - - Acoustic barrier.
 - - - - - Sewer main.
 - - - - - Sewer manhole.
 - - - - - Water main.
 - - - - - Poly water main.

**ACCEPTED
AS CONSTRUCTED**

AS CONSTRUCTED
 Rowlands Surveys Pty Ltd (ACN 010 025 260) hereby certify that the works detailed on this drawing, denoted *, have been constructed to the dimensions and levels shown.
[Signature] Date 26/2/2015
 Director/Registered Surveyor

LAYOUT PLAN

SUNLAND GROUP
 REAL PROPERTY DESCRIPTION
 Lot 903 on SP 239020
 Parish of BOHLE
 County of ELPHINSTONE

In Association with:-
ROWLANDS SURVEYS PTY LTD
 22 GORDEN STREET
 CARBUTT, 4814
 Ph. (07)47755077

LEVEL DATUM A.H.D.
 Horizontal Datum GDA' 94 Zone 55
 Refer P.M. 174438 RL 4.820
 Bolt & washer in kerb.
 Cnr HILLOCK CR. & GLENDOWER ST.
 BASE SURVEY
 Rowlands Surveys (42830/05)
 TRUNCATED COORDINATES
 E 3,000, N 0,000
 EQUIVALENT TO
 E 460000, N 7800000

Scale
 0 5 10 15 20m
 THE ORIGINAL OF THIS DOCUMENT IS COMPLETED TO THE SCALE NOTED.
 AS REPRODUCTION CAN DISTORT SIZE & SHAPE USE ONLY THE DIMENSIONS PROVIDED ON ARCHITECTURAL &/OR ENGINEERING DRAWINGS.
 VERIFY DIMENSIONS ON SITE BEFORE CONSTRUCTION.

All work has been carried out in accordance with LOCAL AUTHORITIES standard details.



NORTHERN CONSULTING
 engineers
 Civil & Structural Engineers
 50 Punari Street, Currajong 4812
 Phone: (07) 4725 5550 Fax: (07) 4725 5850
 Email: mail@noeng.com.au
 Millon Messer & Associates Pty. Ltd.
 ACN 100 817 356

REFER TO DRAWING SUNJ0012/09 FOR ROAD TYPICAL SECTIONS.

B A P2 P1	AMENDED TO AS CONSTRUCTED. ISSUED FOR TENDER / CONSTRUCTION. PRELIMINARY - NOT FOR CONSTRUCTION - ISSUED FOR OFW APPROVAL. PRELIMINARY - NOT FOR CONSTRUCTION - ISSUED FOR CLIENT REVIEW AND APPROVAL ONLY.	24/02/2015 15/09/2014 10/12/2012 18/10/2012
Issue	Description	Date
Drawn JHS Date 10/10/2012	In Association With SUNLAND GROUP LIMITED	LAYOUT PLAN, ROADWORKS & STORMWATER
Checked [Signature]	STAGE 12, 13 TRADITIONAL RESIDENTIAL LOT SUBDIVISION LANFORD STREET BUSHLAND BEACH	Drawing Number SUNJ0012/03
Approved [Signature]		Issue B
COPYRIGHT ©		

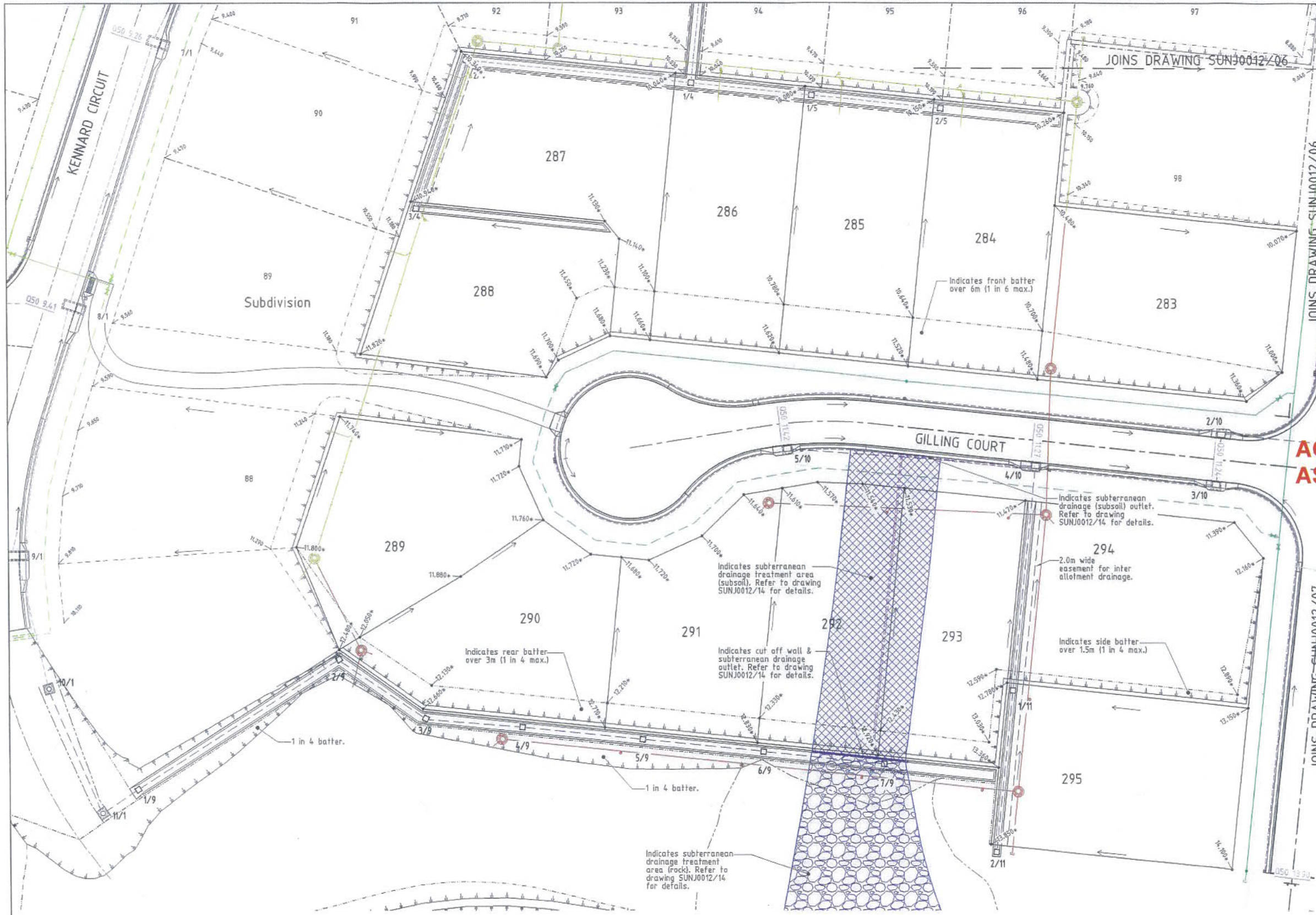

- LEGEND**
- Surface levels.
 - As constructed surface levels.
 - Q50 water surface levels.
 - Subterranean treatment zone (subsoil).
 - Subterranean treatment zone (rack).
 - Stormwater flow arrow.
 - RP boundary.
 - Top of batter.
 - Toe of batter.
 - Change of grade.
 - Stormwater drain line.
 - Subsoil drainage.
 - Sewer main.
 - Sewer manhole.
 - uPVC water main.
 - Poly water main.
 - Sewer main.
 - Sewer manhole.
 - Water main.
 - Poly water main.

NOTES:
 1. All Q50 flows remain within the road reserve.

ACCEPTED AS CONSTRUCTED

AS CONSTRUCTED
 Rowlands Surveys Pty Ltd (ACN 010 025 260) hereby certify that the works detailed on this drawing, denoted *, have been constructed to the dimensions and levels shown.
 Kerry Smith, Director/Registered Surveyor, Date: 26/2/2015

LAYOUT PLAN



REAL PROPERTY DESCRIPTION
 Lot 903 on SP 239020
 Parish of BOHLE
 County of ELPHINSTONE

In Association with:
ROWLANDS SURVEYS PTY LTD
 22 GORDEN STREET
 CARBUTT, 4814
 Ph. (07)47755077

LEVEL DATUM A.M.D.
 Horizontal Datum GDA' 94 Zone 55
 Refer P.M. 174.28 RL. 4.920
 Bolt & washer in kerb.
 Cnr HILLOCK CR. & GLENDOWER ST.
 BASE SURVEY
 Rowlands Surveys (42830/05)
 TRUNCATED COORDINATES
 E 0.000, N 0.000
 EQUIVALENT TO
 E 4.60000, N 7860000

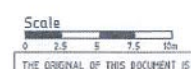

THE ORIGINAL OF THIS DOCUMENT IS COMPLETED TO THE SCALE NOTED. AS REPRODUCTION CAN DISTORT SIZE & SHAPE USE ONLY THE DIMENSIONS PROVIDED ON ARCHITECTURAL &/OR ENGINEERING DRAWINGS. VERIFY DIMENSIONS ON SITE BEFORE CONSTRUCTION.

All work has been carried out in accordance with LOCAL AUTHORITIES standard details.

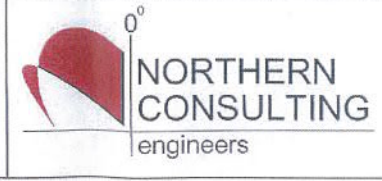

Civil & Structural Engineers
 50 Punari Street, Currajong 4812
 Phone: (07) 4725 6550 Fax: (07) 4725 5850
 Email: mail@nceng.com.au
 Milton Messer & Associates Pty. Ltd
 ACN 100 817 356

Issue	Description	Date
B	AMENDED TO AS CONSTRUCTED.	24/02/2015
A	ISSUED FOR TENDER / CONSTRUCTION.	15/09/2014
P3	PRELIMINARY - NOT FOR CONSTRUCTION - SUBSOIL SUBTERRANEAN DETAIL ADDED - ISSUED FOR GPW APPROVAL.	11/12/2012
P2	PRELIMINARY - NOT FOR CONSTRUCTION - ISSUED FOR GPW APPROVAL.	11/12/2012
P1	PRELIMINARY - NOT FOR CONSTRUCTION - ISSUED FOR CLIENT REVIEW AND APPROVAL ONLY.	10/10/2012

Drawn JHS	In Association with SUNLAND GROUP LIMITED	CUT/FILL LAYOUT PLAN
Date 10/10/2012		
Checked AS	STAGE 12, 13 TRADITIONAL RESIDENTIAL LOT SUBDIVISION	Drawing Number SUNJ0012/05
Approved AS		
COPYRIGHT ©		

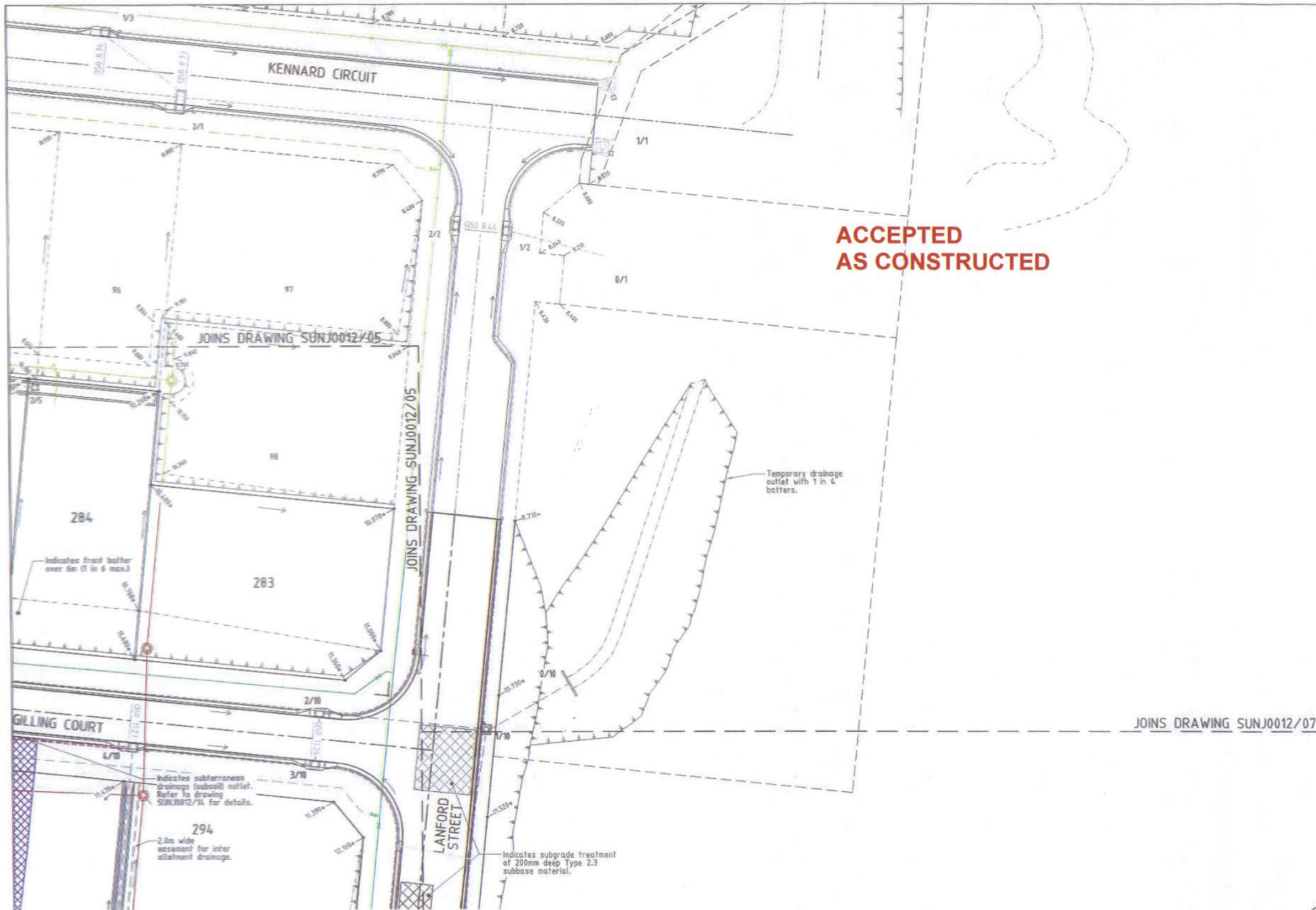

- LEGEND**
- 12.000 - Surface levels.
 - 12.000* - As constructed surface levels.
 - 0.50 8.00 - Q50 water surface levels.
 - [Cross-hatched box] - Subterranean treatment zone (subsoil).
 - [Arrow] - Stormwater flow arrow.
 - [Dashed line] - RP boundary.
 - [Dashed line with ticks] - Top of batter.
 - [Dashed line with ticks] - Toe of batter.
 - [Dashed line] - Change of grade.
 - [Dashed line] - Stormwater drain line.
 - [Dashed line] - Subsoil drainage.
 - [Red line with circle] - Sewer main.
 - [Red line with circle] - Sewer manhole.
 - [Red line with circle] - uPVC water main.
 - [Red line with circle] - Poly water main.
 - [Green line with circle] - Sewer main.
 - [Green line with circle] - Sewer manhole.
 - [Green line with circle] - Water main.
 - [Green line with circle] - Poly water main.

NOTES:
 1. All Q50 flows remain within the road reserve.

LAYOUT PLAN

AS CONSTRUCTED
 Rowlands Surveys Pty Ltd (ACN 010 025 260) hereby certify that the works detailed on this drawing, denoted *, have been constructed to the dimensions and levels shown.
 [Signature] Date: 26/2/2015
 Director/Registered Surveyor

SUNLAND GROUP
REAL PROPERTY DESCRIPTION
 Lot 903 on SP 239029
 Parish of BOHLE
 County of ELPHINSTONE

In Association with:
ROWLANDS SURVEYS PTY LTD
 22 GORDON STREET
 GARBUTT, 4014
 Ph. (07)47755077

LEVEL DATUM A.M.D.
 Horizontal Datum GDA '94 Zone 55
 Refer P.M. 174438 RL 4.820
 Belt & washer in herb.
 Cor HILLOCK CR & GLENDOWER ST.

BASE SURVEY
 Rowlands Surveys (42830/05)
 TRUNCATED COORDINATES
 E 0.000, N 0.000
 EQUIVALENT TO
 E 468000, N 7000000

Scale
 0 2.5 5 7.5 10m

THE ORIGINAL OF THIS DOCUMENT IS COMPLETED TO THE SCALE NOTED.
 AS REPRODUCTION CAN DISTORT SIZE & SHAPE USE ONLY THE DIMENSIONS PROVIDED ON ARCHITECTURAL &/OR ENGINEERING DRAWINGS.
 VERIFY DIMENSIONS ON SITE BEFORE CONSTRUCTION.

All work has been carried out in accordance with LOCAL AUTHORITIES standard details.



Civil & Structural Engineers
 50 Punari Street, Curralong 4812
 Phone: [07] 4725 5550 Fax: [07] 4725 5850
 Email: mail@nceng.com.au
 Milton Messer & Associates Pty Ltd.
 ACN 100 817 355

B	AMENDED TO AS CONSTRUCTED.	24/02/2015
A	ISSUED FOR TENDER / CONSTRUCTION.	15/09/2014
P3	PRELIMINARY - NOT FOR CONSTRUCTION - SUBSOIL SUBTERRANEAN DETAIL ADDED - ISSUED FOR OPW APPROVAL.	11/12/2012
P2	PRELIMINARY - NOT FOR CONSTRUCTION - ISSUED FOR OPW APPROVAL.	11/12/2012
P1	PRELIMINARY - NOT FOR CONSTRUCTION - ISSUED FOR CLIENT REVIEW AND APPROVAL ONLY.	10/10/2012

Issue	Description	Date
Drawn	JHS	
Date	10/10/2012	
Checked	[Signature]	
Approved	[Signature]	

In Association With	SUNLAND GROUP LIMITED
STAGE 12, 13 TRADITIONAL RESIDENTIAL LOT SUBDIVISION	
LANFORD STREET	
BUSHLAND BEACH	
Drawing Number	SUNJ0012/06
Issue	B

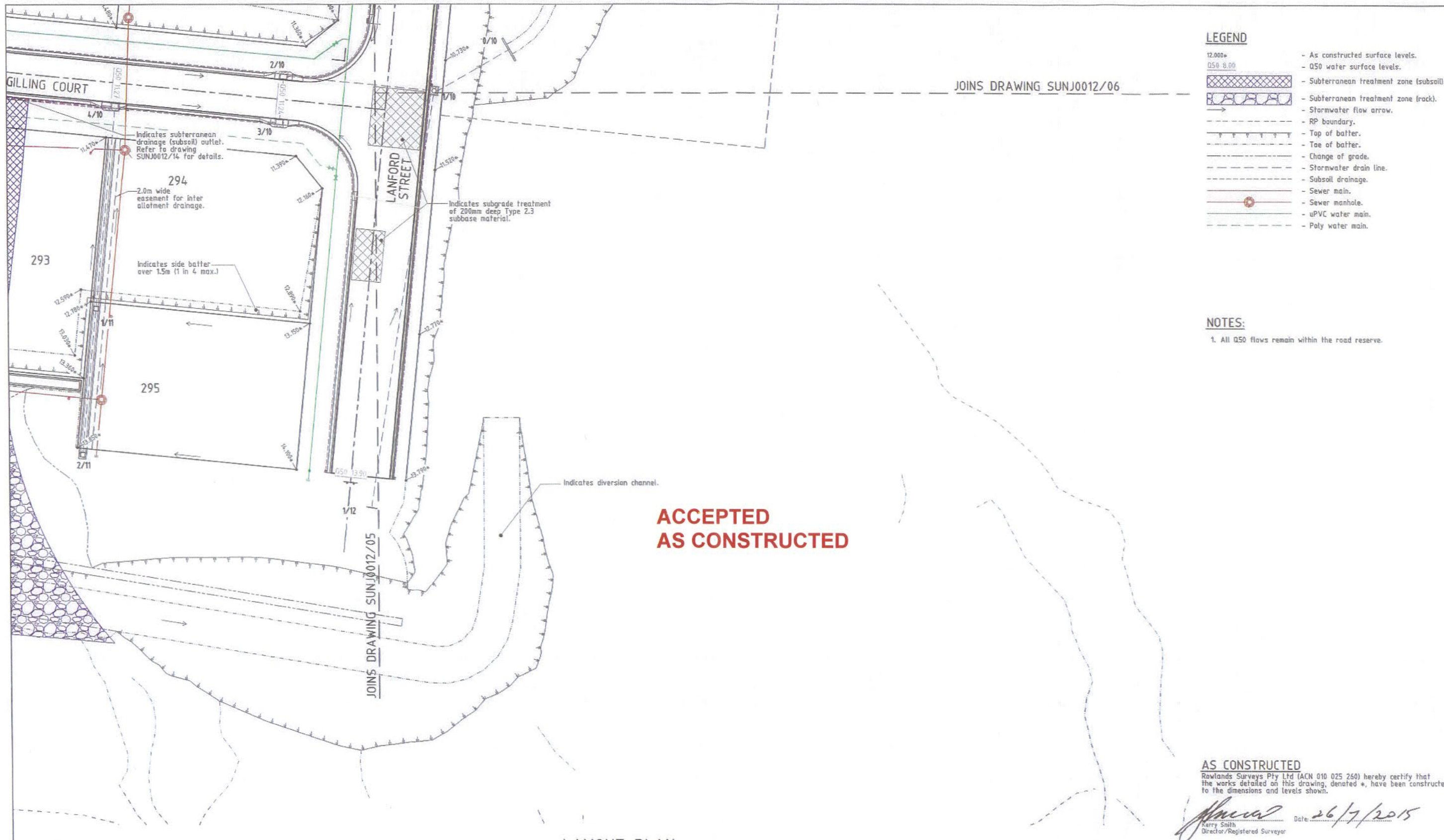

- LEGEND**
- 12.000+ - As constructed surface levels.
 - 050 8.00 - Q50 water surface levels.
 - [Cross-hatched pattern] - Subterranean treatment zone (subsoil).
 - [Wavy pattern] - Subterranean treatment zone (rock).
 - [Arrow] - Stormwater flow arrow.
 - [Dashed line] - RP boundary.
 - [Dashed line with triangles] - Top of batter.
 - [Dashed line with triangles] - Toe of batter.
 - [Dashed line] - Change of grade.
 - [Dashed line] - Stormwater drain line.
 - [Dashed line] - Subsoil drainage.
 - [Circle with cross] - Sewer main.
 - [Circle with cross] - Sewer manhole.
 - [Circle with cross] - uPVC water main.
 - [Dashed line] - Poly water main.

NOTES:

- All Q50 flows remain within the road reserve.

ACCEPTED AS CONSTRUCTED

AS CONSTRUCTED
 Rowlands Surveys Pty Ltd (ACN 010 025 250) hereby certify that the works detailed on this drawing, denoted *, have been constructed to the dimensions and levels shown.

[Signature] Date: 26/7/2015
 Kerry Smith
 Director/Registered Surveyor

LAYOUT PLAN



REAL PROPERTY DESCRIPTION
 Lot 903 on SP 239020
 Parish of BOHLE
 County of ELPHINSTONE

In Association with:-

ROWLANDS SURVEYS PTY LTD
 22 GORDEN STREET
 CARBUTT, 4814
 Ph. (07)47755077

LEVEL DATUM A.H.D.
 Horizontal Datum GDA' 94 Zone 55
 Refer P.M. 174430 RL 4.820
 Bolt & washer in kerb.
 Cor HILLOCK CR. & GLENDOWER ST.

BASE SURVEY
 Rowlands Surveys (42830/05)
 TRUNCATED COORDINATES
 E 0.000, N 0.000
 EQUIVALENT TO
 E 460000, N 7800000

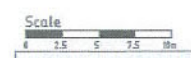

THE ORIGINAL OF THIS DOCUMENT IS COMPLETED TO THE SCALE NOTED. AS REPRODUCTION CAN DISTORT SIZE & SHAPE USE ONLY THE DIMENSIONS PROVIDED BY ARCHITECTURAL &/OR ENGINEERING DRAWINGS. VERIFY DIMENSIONS ON SITE BEFORE CONSTRUCTION.

All work has been carried out in accordance with LOCAL AUTHORITIES standard details.



NORTHERN CONSULTING
 engineers

Civil & Structural Engineers
 50 Punari Street, Currajong 4812
 Phone: [07] 4725 5550 Fax: [07] 4725 5850
 Email: mail@nceng.com.au
 Milton Messer & Associates Pty. Ltd.
 ACN 100 817 358

Issue	Description	Date
B	AMENDED TO AS CONSTRUCTED.	24/02/2015
A	ISSUED FOR TENDER / CONSTRUCTION.	15/09/2014
P3	PRELIMINARY - NOT FOR CONSTRUCTION - SUBSOIL SUBTERRANEAN DETAIL ADDED - ISSUED FOR OPW APPROVAL.	11/12/2012
P2	PRELIMINARY - NOT FOR CONSTRUCTION - ISSUED FOR OPW APPROVAL.	11/12/2012
P1	PRELIMINARY - NOT FOR CONSTRUCTION - ISSUED FOR CLIENT REVIEW AND APPROVAL ONLY.	10/10/2012

Drawn JHS Date 10/10/2012	In Association With SUNLAND GROUP LIMITED	CUT/FILL LAYOUT PLAN
Checked AS Approved [Signature]	STAGE 12, 13 TRADITIONAL RESIDENTIAL LOT SUBDIVISION LANFORD STREET BUSHLAND BEACH	
COPYRIGHT ©		Drawing Number SUNJ0012/07
		Issue B

PAVEMENT TABLE

PAVEMENT TYPE	PAVEMENT DESCRIPTION
TYPE 1	30mm DG10 Asphalt. Prime. 100mm Base course gravel Type 2.1 CBR 80 (approved alternate Type 2.3) 120mm Sub-base course gravel Type 2.3 CBR 45

**ACCEPTED
AS CONSTRUCTED**

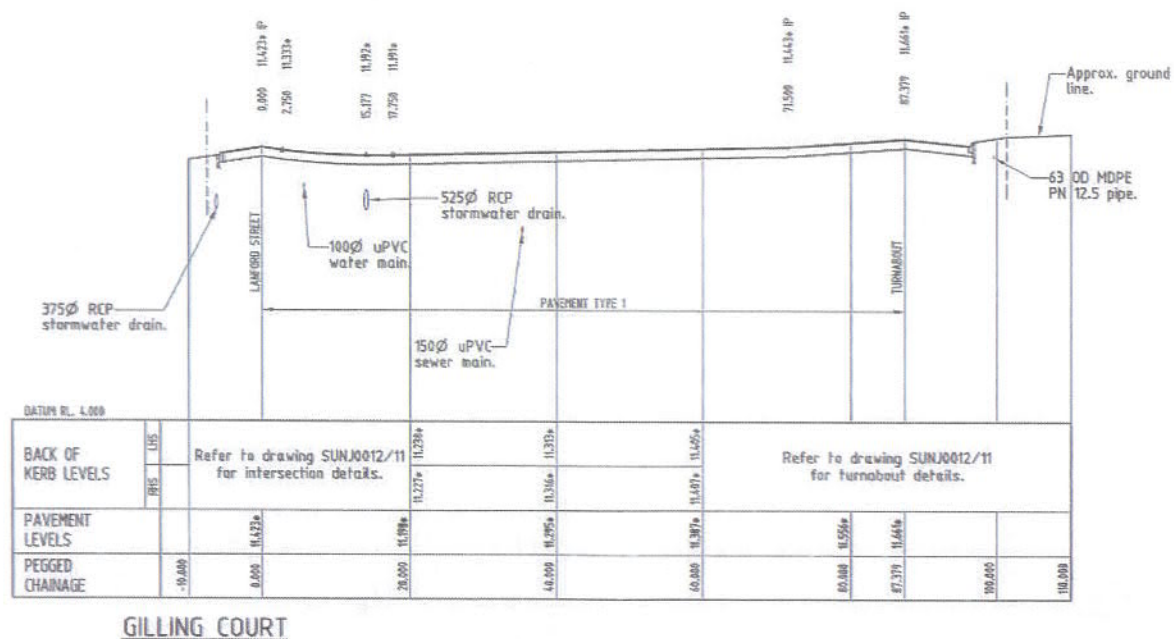
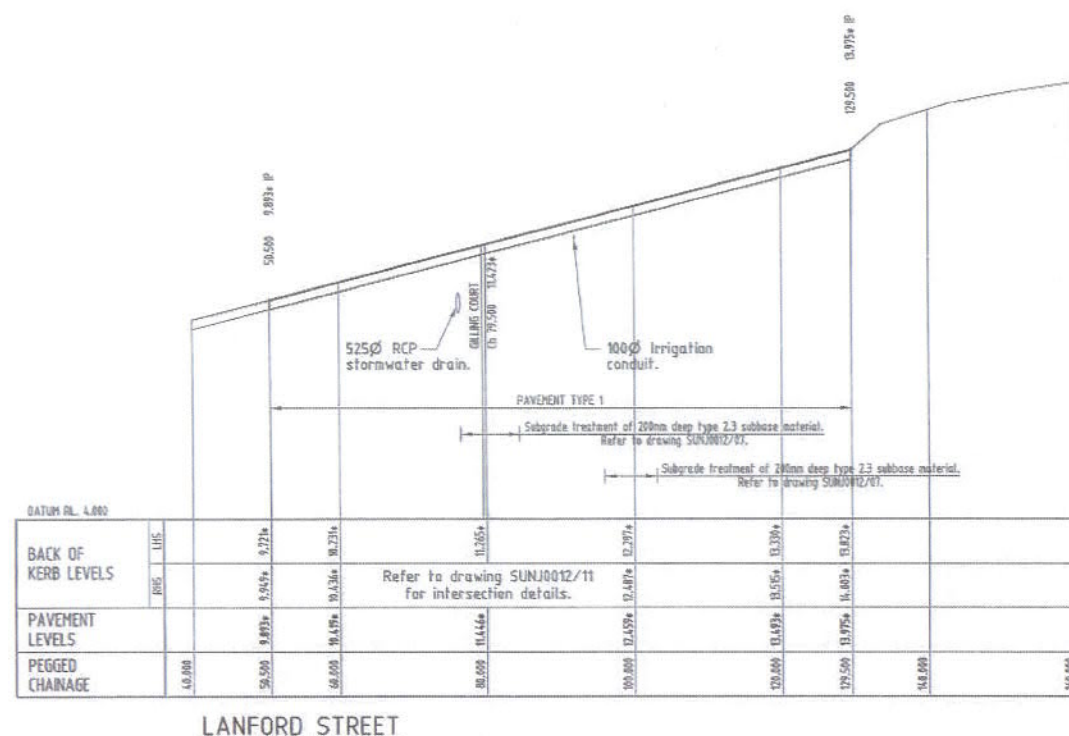

LONGITUDINAL SECTIONS

Scale 'A' - Horizontal
Scale 'B' - Vertical

AS CONSTRUCTED

Northern Consulting Engineers hereby certify that the works detailed on this drawing have been constructed to the dimensions and levels detailed.

Derek Robert Conley Saw

Date: 26/2/15

AS CONSTRUCTED

Rowlands Surveys Pty Ltd (ACN 010 025 260) hereby certify that the works detailed on this drawing, denoted *, have been constructed to the dimensions and levels shown.

Kerry Smith
Director/Registered Surveyor

Date: 26/2/2015

All work has been carried out in accordance with LOCAL AUTHORITIES standard details.

REFER TO DRAWING SUNJ0012/09 FOR ROAD TYPICAL SECTIONS.



REAL PROPERTY DESCRIPTION
Lot 903 on SP 239020
Parish of BOHLE
County of ELPHINSTONE



ROWLANDS SURVEYS PTY LTD
22 GORDEN STREET
GARBUTT, 4814
Ph. (07)47755077

LEVEL DATUM A.H.D.
Horizontal Datum GDA' 94 Zone 55
Refer P.H. 17443B RL 4.820
Bolt & washer in kerb.
Cnr HILLOCK CR. & GLENDOWER ST.

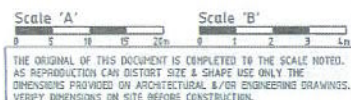

Civil & Structural Engineers
50 Punari Street, Currajong 4812
Phone: [07] 4725 5550 Fax: [07] 4725 5850
Email: mail@nceng.com.au
Hilton Messer & Associates Pty. Ltd.
ACN 100 817 356

Issue	Description	Date
B	AMENDED TO AS CONSTRUCTED.	24/02/2015
A	ISSUED FOR TENDER / CONSTRUCTION.	15/05/2014
P2	PRELIMINARY - NOT FOR CONSTRUCTION - ISSUED FOR OPW APPROVAL.	11/12/2012
P1	PRELIMINARY - NOT FOR CONSTRUCTION - ISSUED FOR CLIENT REVIEW AND APPROVAL ONLY.	10/10/2012

Drawn	In Association With	ROAD LONGITUDINAL SECTIONS
RHS	SUNLAND GROUP LIMITED	
Date		
10/10/2012		
Checked	STAGE 12, 13 TRADITIONAL	
APPROVED	RESIDENTIAL LOT SUBDIVISION	
	LANFORD STREET	
	BUSHLAND BEACH	
COPYRIGHT ©		

Drawing Number	Issue
SUNJ0012/08	B

**ACCEPTED
AS CONSTRUCTED**

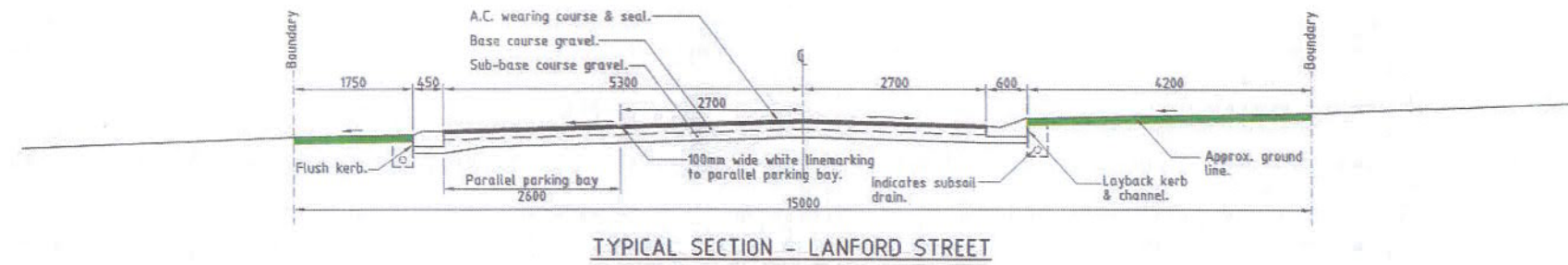
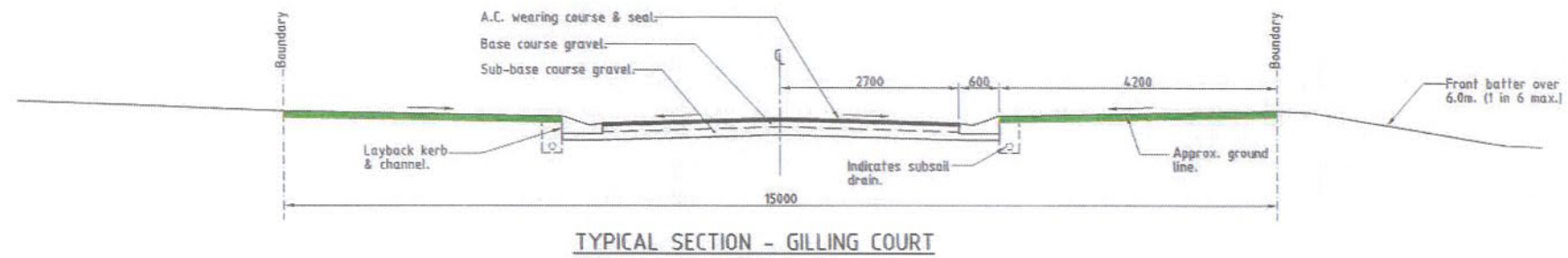

AS CONSTRUCTED

Northern Consulting Engineers hereby certify that the works detailed on this drawing have been constructed to the dimensions and levels detailed.

[Signature]
Derek Robert Colley Saw Date: 26-2-15



REAL PROPERTY DESCRIPTION
Lot 903 on SP 239020
Parish of BOHLE
County of ELPHINSTONE

In Association with:-



ROWLANDS SURVEYS PTY LTD
22 GORDEN STREET
GARBUTT, 4814
Ph. (07)47755077

LEVEL DATUM A.M.D.
Horizontal Datum GDA' 94 Zone 55
Refer P.M. 174438 RL. 4.820
Bolt & washer in kerb.
Cnr HILLOCK CR. & GLENDOWER ST.
BASE SURVEY
Rowlands Surveys (1,7830/05)
TRUNCATED COORDINATES
E 0.000, N 0.000
EQUIVALENT TO
E 4,60000, N 7800000

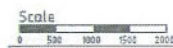

THE ORIGINAL OF THIS DOCUMENT IS COMPLETED TO THE SCALE NOTED.
AS REPRODUCTION CAN DISTORT SIZE & SHAPE USE ONLY THE
DIMENSIONS PROVIDED ON ARCHITECTURAL &/OR ENGINEERING DRAWINGS.
VERIFY DIMENSIONS ON SITE BEFORE CONSTRUCTION.

All work has been carried out in accordance with LOCAL AUTHORITIES standard details.

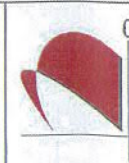

Civil & Structural Engineers
50 Punari Street, Currajong 4812
Phone: (07) 4725 5550 Fax: (07) 4725 5850
Email: mail@nceng.com.au
Milton Messer & Associates Pty. Ltd.
ACN 100 817 255

B	AMENDED TO AS CONSTRUCTED.	24/02/2015
A	ISSUED FOR TENDER / CONSTRUCTION.	15/09/2014
P2	PRELIMINARY - NOT FOR CONSTRUCTION - ISSUED FOR OPW APPROVAL.	11/12/2012
P1	PRELIMINARY - NOT FOR CONSTRUCTION - ISSUED FOR CLIENT REVIEW AND APPROVAL ONLY.	10/10/2012
Issue	Description	Date
Drawn JHS Date 10/10/2012	In Association With SUNLAND GROUP LIMITED	ROAD TYPICAL SECTIONS
Checked [Signature]	STAGE 12, 13 TRADITIONAL RESIDENTIAL LOT SUBDIVISION LANFORD STREET BUSHLAND BEACH	
Drawing Number SUNJ0012/09		Issue B

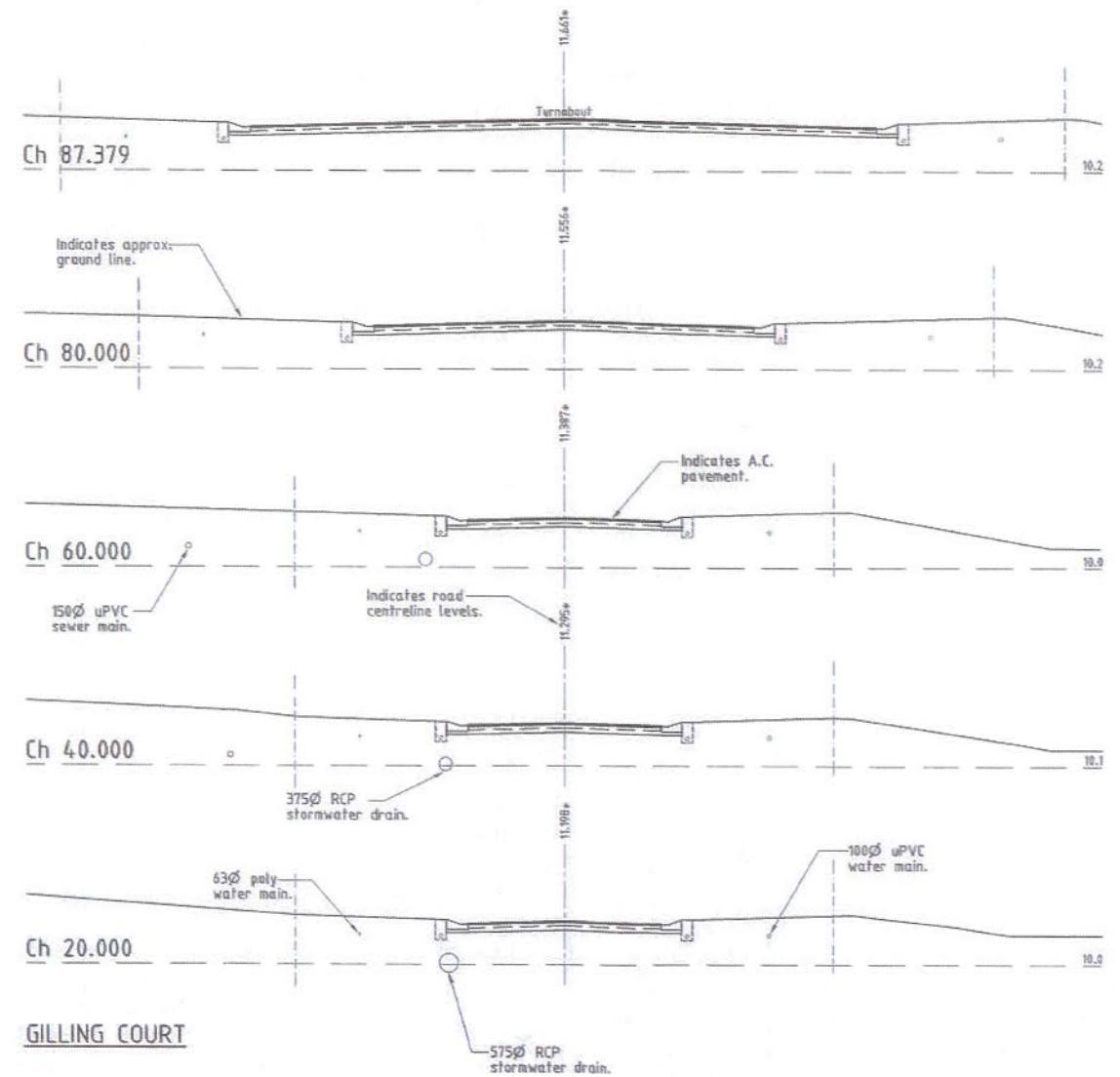
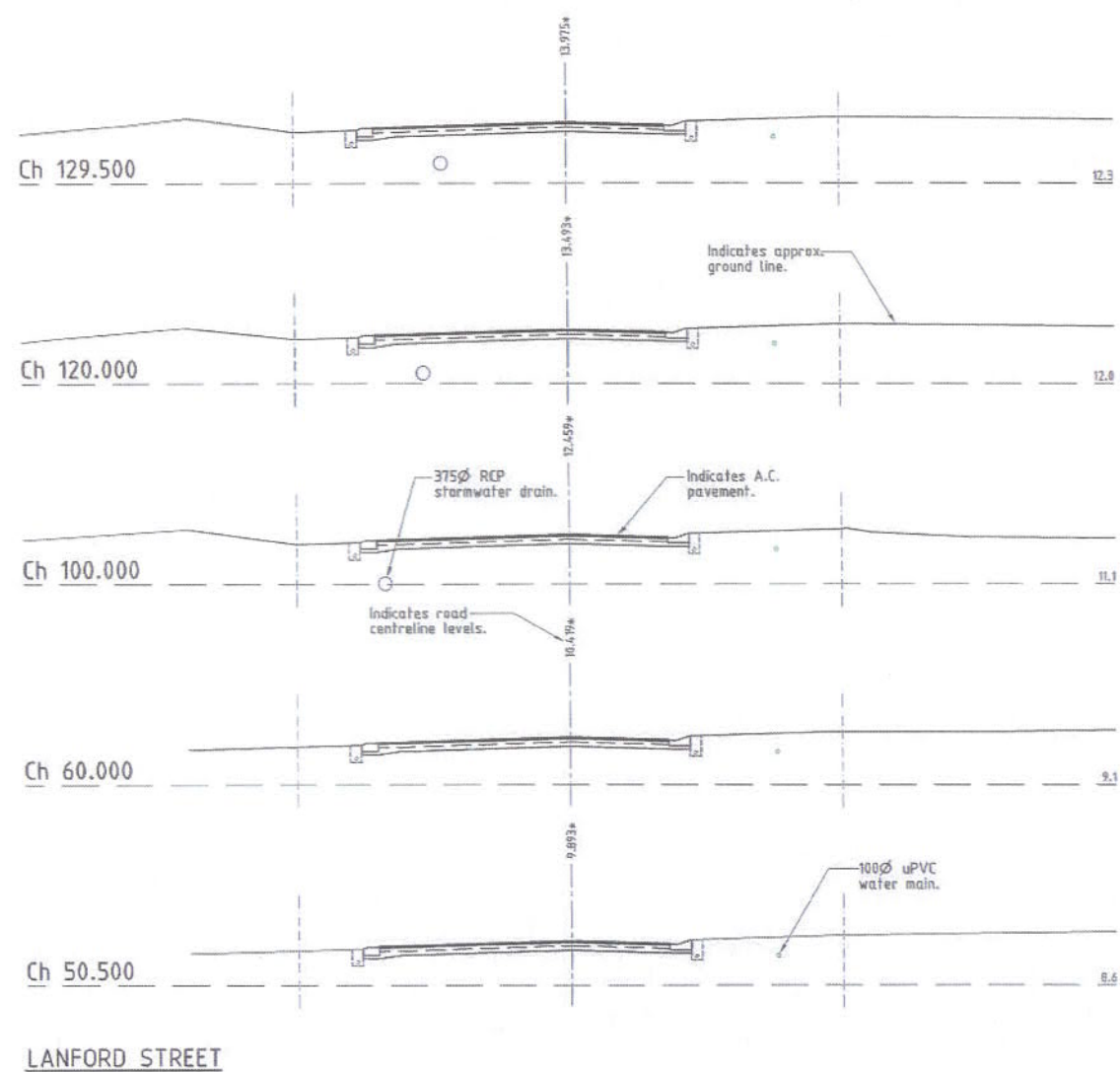

**ACCEPTED
AS CONSTRUCTED**
CROSS SECTIONS

AS CONSTRUCTED
Rowlands Surveys Pty Ltd (ACN 010 025 260) hereby certify that the works detailed on this drawing, denoted *, have been constructed to the dimensions and levels shown.

Kerry Smith
Kerry Smith
Director/Registered Surveyor
Date: 26/2/2015

All work has been carried out in accordance with LOCAL AUTHORITIES standard details.

REFER TO DRAWING SUNJ0012/09 FOR ROAD TYPICAL SECTIONS.

B	AMENDED TO AS CONSTRUCTED.	24/02/2015
A	ISSUED FOR TENDER / CONSTRUCTION.	15/07/2014
P2	PRELIMINARY - NOT FOR CONSTRUCTION - ISSUED FOR OPW APPROVAL.	11/12/2012
P1	PRELIMINARY - NOT FOR CONSTRUCTION - ISSUED FOR CLIENT REVIEW AND APPROVAL ONLY.	10/01/2012



REAL PROPERTY DESCRIPTION
Lot 903 on SP 239020
Parish of BOHLE
County of ELPHINSTONE



ROWLANDS SURVEYS PTY LTD
22 GORDON STREET
GARbutt, 4814
Ph. (07)47755077

LEVEL DATUM A.H.D.
Horizontal Datum GDA' 94 Zone 55
Refer P.M. 17438 RL, 4.820
Bolt & washer in kerb.
Cnr HILLOCK CR. & GLENDOWER ST.
BASE SURVEY
Rowlands Surveys (42830/05)
TRUNCATED COORDINATES
E 0.000 N 0.000
EQUIVALENT TO
E 460000, N 7800000



THE ORIGINAL OF THIS DOCUMENT IS COMPLETED TO THE SCALE NOTED. AS REPRODUCTION CAN DISTORT SIZE & SHAPE USE ONLY THE DIMENSIONS PROVIDED ON ARCHITECTURAL &/OR ENGINEERING DRAWINGS. VERIFY DIMENSIONS ON SITE BEFORE CONSTRUCTION.

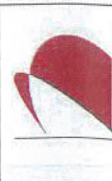

NORTHERN CONSULTING
engineers
Civil & Structural Engineers
50 Punari Street, Currajong 4812
Phone: (07) 4725 5550 Fax: (07) 4725 5850
Email: mail@nceng.com.au
Milken Messer & Associates Pty. Ltd.
ACN 100 817 356

Drawn JHS Date 10/10/2012 Checked AS Approved AS	In Association With SUNLAND GROUP LIMITED STAGE 12, 13 TRADITIONAL RESIDENTIAL LOT SUBDIVISION LANFORD STREET BUSHLAND BEACH	ROAD CROSS SECTIONS Drawing Number SUNJ0012/10 Issue B
---	--	--

