

- ### NOTES:
- All sewer manholes are 1050Ø unless shown otherwise.
 - All sewer manhole covers are class 'B' unless shown otherwise.
 - All 150Ø sewer mains & fittings shall be uPVC class SN8.

SEWER MANHOLES

Manhole No.	Easting	Northing	Manhole Type
4/12A6a	5586.53*	76633.28*	Standard
5/12A6a	5552.33*	76571.96*	Standard
9/12A6a2	5353.23*	76568.70*	Standard
10/12A6a2	5386.03*	76519.01*	Standard
1/12A6a3	5525.64*	76591.10*	Standard
2/12A6a3	5502.73*	76593.57*	Standard
3/12A6a3	5483.43*	76609.62*	Standard
4/12A6a3	5462.02*	76594.61*	Standard
5/12A6a3	5418.13*	76559.73*	Standard
6/12A6a3	5405.73*	76580.30*	Shallow

- All dimensions are to centre of chamber.

TOWNSVILLE CITY COUNCIL
 REC'D 14 JAN 2011
 TOWN PLANNING

AS CONSTRUCTED LAYOUT PLAN

I John James Rowlands of ROWLANDS SURVEYS Pty. Ltd. hereby certify that this drawing accurately describes and records the nature and the location of the works depicted herein as they have been constructed for the purposes of the development.

John Rowlands 22.12.10
 Director/Registered Surveyor

REAL PROPERTY DESCRIPTION

Lots 501 & 502 on SP 162413
 Parish of BOHLE
 County of ELPHINSTONE
 Bilbao Place - Bushland Beach

In Association with:-

ROWLANDS SURVEYS PTY LTD
 22 GORDEN STREET
 GARBUTT. 4814
 Ph. (07)47755077

SUNLAND GROUP

LEVEL DATUM A.H.D.
 Horizontal Datum GDA '94 Zone 55
 Refer P.M. 138403 RL. 8.545
 Bolt & washer in manhole top.
 LYNWOOD AVENUE

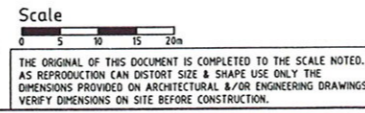

"*" - Indicates As Constructed information.

All work carried out in accordance with the former THURINGOWA CITY COUNCIL standard details.

NORTHERN CONSULTING
 engineers

Civil & Structural Engineers
 50 Punari Street, Currango 4812
 Phone: 07 4725 5550 Fax: 07 4725 5850
 Email: mail@nceng.com.au
 Milton Munnell & Associates Pty. Ltd.
 ACN 100 817 355

Issue	Description	Date
E	AMENDED TO AS CONSTRUCTED.	21/12/2010
D	AMENDMENTS AS PER COUNCIL REQUEST FOR INFORMATION.	30/04/2010
C	ISSUED FOR CONSTRUCTION.	30/03/2010
B	BILBAO PLACE DESIGN AMENDED & BENCHING TO ALLOTMENTS ADDED.	24/03/2010
A	ISSUED FOR CONSTRUCTION.	21/07/2008
P1	PRELIMINARY - NOT FOR CONSTRUCTION - AMENDED TO COUNCIL REQUIREMENTS.	02/11/2007
P2	PRELIMINARY - NOT FOR CONSTRUCTION - ISSUED FOR OPERATIONAL WORKS APPROVAL.	02/11/2007

Drawn	In Association with	SEWERAGE RETICULATION PLAN
TM	SUNLAND GROUP LIMITED	Drawing Number
Date	02/11/2007	SUN85/13
Checked	STAGE 85, 26 TRADITIONAL RESIDENTIAL LOT SUBDIVISION	Issue
Approved	BILBAO PLACE BUSHLAND BEACH	E

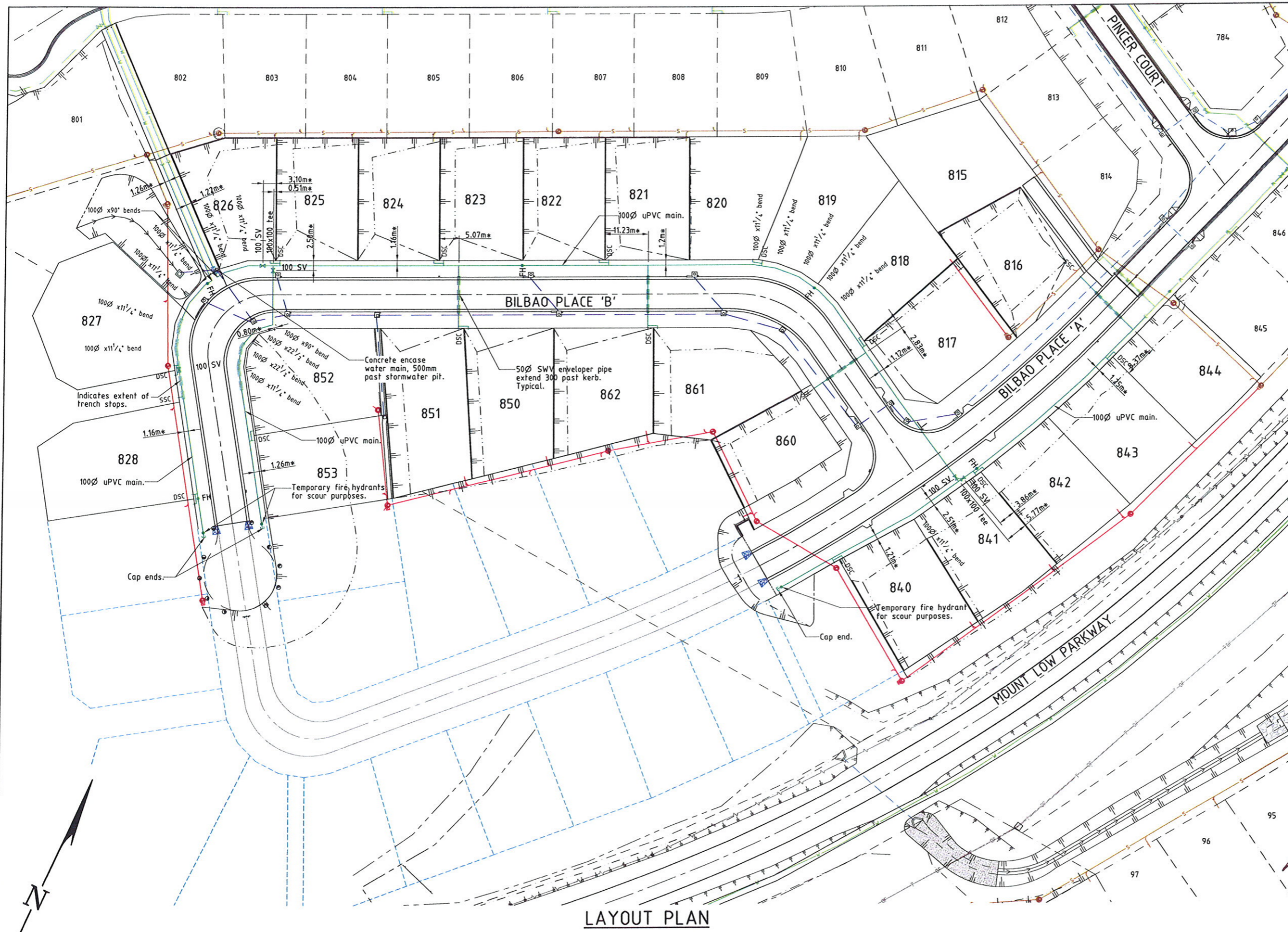

- LEGEND**
GENERAL:-
- Top of batter.
 - Toe of batter.
 - Invert of creek/drain.
 - Stormwater drain line.
 - Sewer main.
 - Sewer manhole.
 - Water main.
 - Stormwater drain line.
 - Sewer main.
 - Sewer manhole.
 - Water main.
 - Poly water main.
 - Overhead power line.
 - Telstra conduit.

- WATER RETICULATION:-**
- FH Fire Hydrant.
 - SV Stop Valve.
 - DSC Double Service Connection.
 - SSC Single Service Connection.

- NOTES:**
- All water service connections have been installed in accordance with the former Thuringowa City Council standards, ie. 1.2m 100mm offset from property boundary. U.N.O.
 - All water supply fixtures (FH, SV etc.) have been installed in accordance with the former Thuringowa City Council standards, ie. adjacent to property boundary intersection. U.N.O.
 - All uPVC water mains are Class 16 cast iron outside diameter compatible. Unless noted otherwise.

APPROVED

AS CONSTRUCTED
I John James Rowlands of ROWLANDS SURVEYS Pty. Ltd. hereby certify that this drawing accurately describes and records the nature and the location of the works depicted herein as they have been constructed for the purposes of the development.

John James Rowlands Date: 22.12.10
John James Rowlands
Director/Registered Surveyor

TOWNSVILLE CITY COUNCIL
REC'D 14 JAN 2011
TOWN PLANNING

REAL PROPERTY DESCRIPTION

Lots 501 & 502 on SP 162413
Parish of BOHLE
County of ELPHINSTONE
Bilbao Place - Bushland Beach

In Association with:-

ROWLANDS SURVEYS PTY LTD
22 GORDEN STREET
GARBUTT. 4814
Ph. (07)47755077



LEVEL DATUM A.H.D.
Horizontal Datum GDA' 94 Zone 55
Refer P.M. 138403 RL. 8.545
Bolt & washer in manhole top.
LYNWOOD AVENUE

Scale
0 5 10 15 20m
THE ORIGINAL OF THIS DOCUMENT IS COMPLETED TO THE SCALE NOTED.
AS REPRODUCTION CAN DISTORT SIZE & SHAPE USE ONLY THE DIMENSIONS PROVIDED ON ARCHITECTURAL &/OR ENGINEERING DRAWINGS.
VERIFY DIMENSIONS ON SITE BEFORE CONSTRUCTION.

"*" - Indicates As Constructed information.
All work carried out in accordance with the former THURINGOWA CITY COUNCIL standard details.

NORTHERN CONSULTING
engineers
Civil & Structural Engineers
50 Punari Street, Currasjong 4812
Phone: 07 4725 5550 Fax: 07 4725 5850
Email: mail@nceng.com.au
Milton Messner & Associates Pty. Ltd.
ACN 100 817 956

Issue	Description	Date
E	AMENDED TO AS CONSTRUCTED.	21/12/2010
D	ISSUED FOR CONSTRUCTION - FIRE HYDRANTS RELOCATION.	22/07/2010
B	BILBAO PLACE DESIGN AMENDED & BENCHING TO ALLOTMENTS ADDED.	24/03/2010
A	ISSUED FOR CONSTRUCTION.	21/07/2008
P2	PRELIMINARY - NOT FOR CONSTRUCTION - AMENDED TO COUNCIL REQUIREMENTS.	11/01/2008
P1	PRELIMINARY - NOT FOR CONSTRUCTION - ISSUED FOR OPERATIONAL WORKS APPROVAL.	02/11/2007

Drawn TM	In Association with SUNLAND GROUP LIMITED	WATER RETICULATION PLAN
Date 02/11/2007	STAGE 85, 26 TRADITIONAL RESIDENTIAL LOT SUBDIVISION BILBAO PLACE BUSHLAND BEACH	
Checked		Drawing Number SUN85/14
Approved		Issue E
COPYRIGHT ©		