

EXPANSION JOINT (EJ)
Scale 'C'

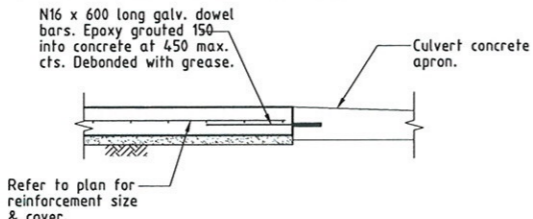

DOWEL JOINT (DX)
Scale 'C'

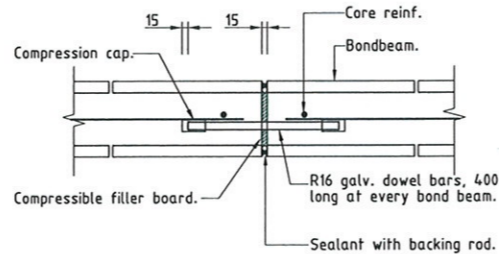

VERTICAL CONTROL JOINT (VCJ)
Scale 'D'

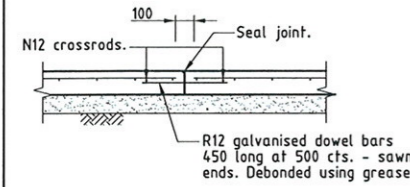

SLAB JOINT (SJ)
Scale 'C'

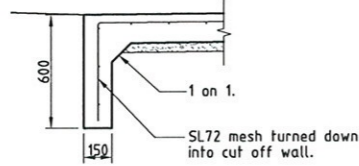

CUT OFF WALL (TYPICAL)
Scale 'C'

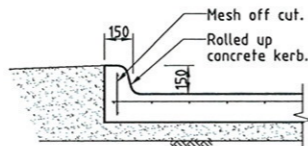

ROLLED UP KERB
Scale 'C'

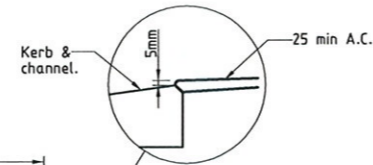

Kerb & channel
Scale 'D'

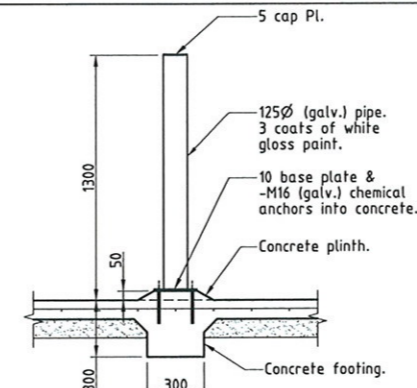

BOLLARD DETAIL
Scale 'C'

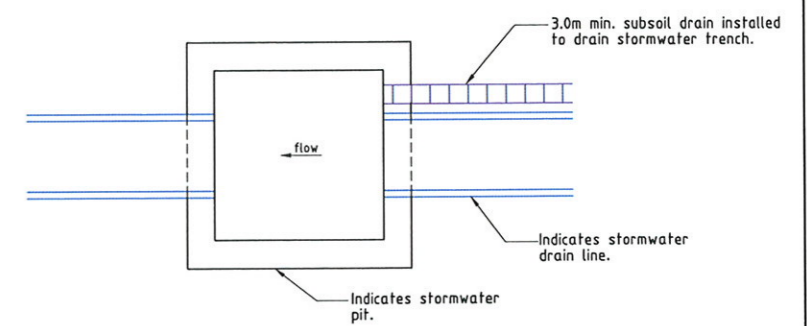

SUBSOIL DRAIN INTO PIT (TYPICAL)

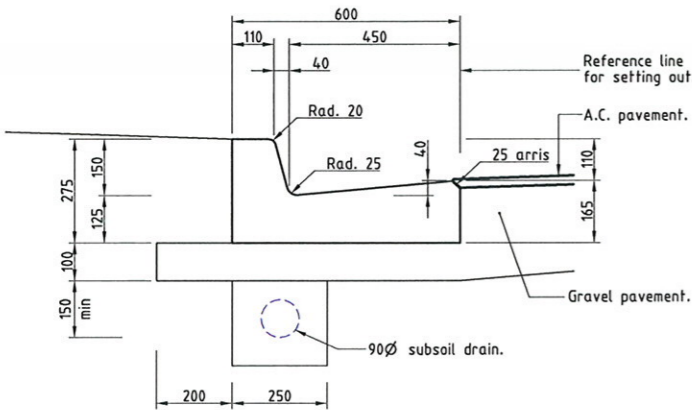

BARRIER KERB & CHANNEL
Scale 'D'

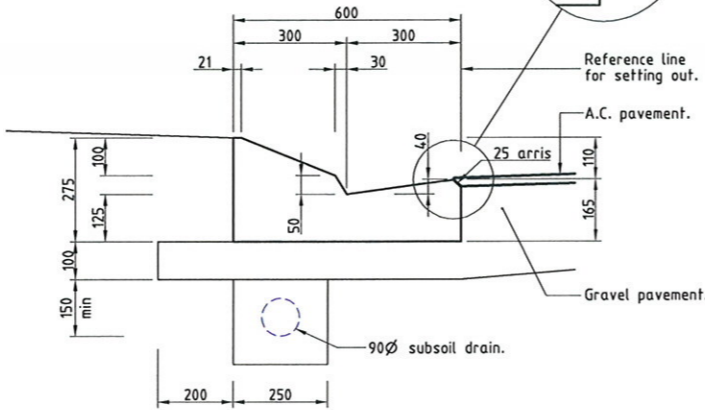

LAYBACK KERB & CHANNEL
Scale 'D'

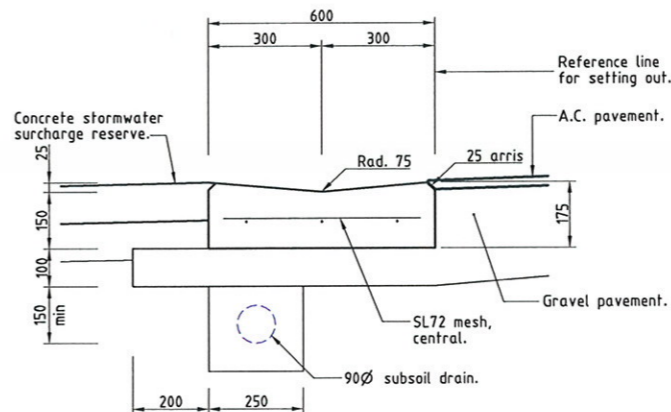

600 WIDE DISH DRAIN
Scale 'D'

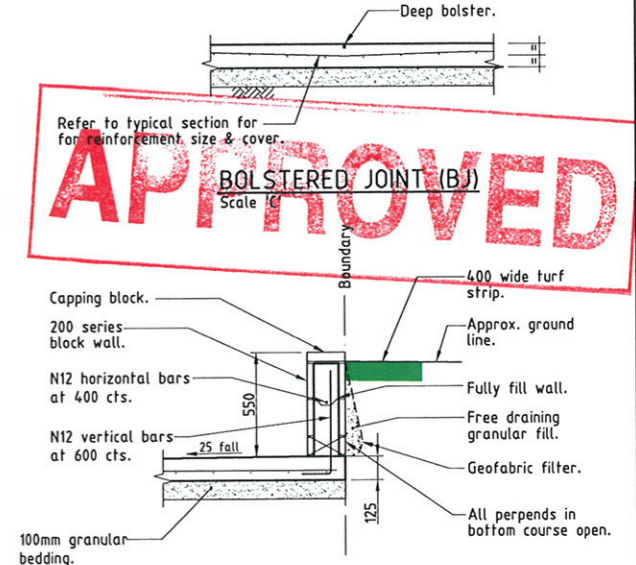

APPROVED
BOLSTERED JOINT (BJ)
Scale 'C'

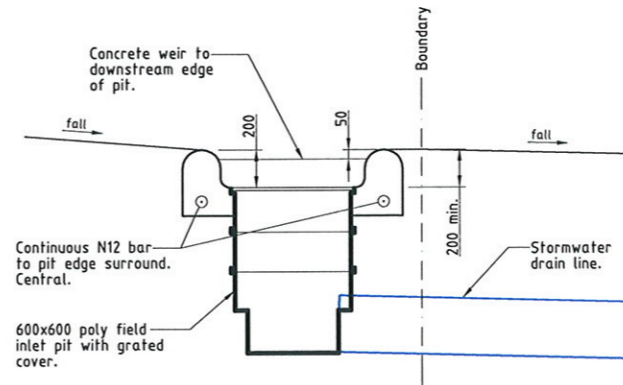

600x600 POLY FIELD INLET PIT (TYPICAL)
Scale 'C'

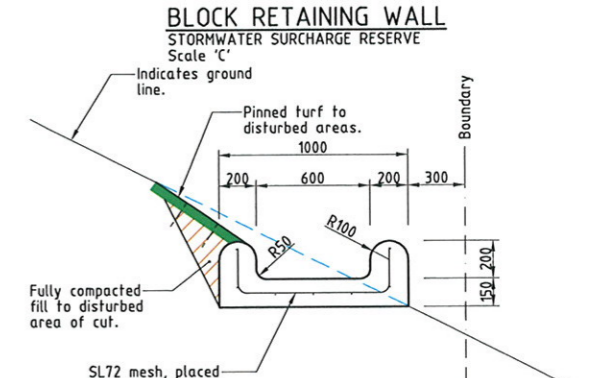

**BLOCK RETAINING WALL
STORMWATER SURCHARGE RESERVE**
Scale 'C'

Indicates edge of pavement.

Refer to drawing SUN84/7 for road longitudinal section.

DATUM RL 21.000

PAVEMENT LEVELS	-10.000	-5.000	0.000	23.046*	23.444*	23.880*	24.283*	24.550*	24.701*	24.740*	24.683*	24.477*	23.751*	23.311*	22.941*	22.941*	22.941*
CHAINAGE																	

Refer to drawing SUN84/7 for road longitudinal section.

CUL-DE-SAC LIP LONGITUDINAL SECTION
Scale 'A' - Horizontal
Scale 'B' - Vertical

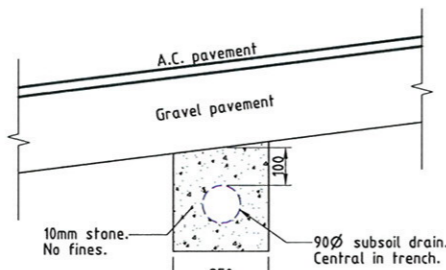

TRANSVERSE SUBSOIL DRAINAGE
Scale 'D'

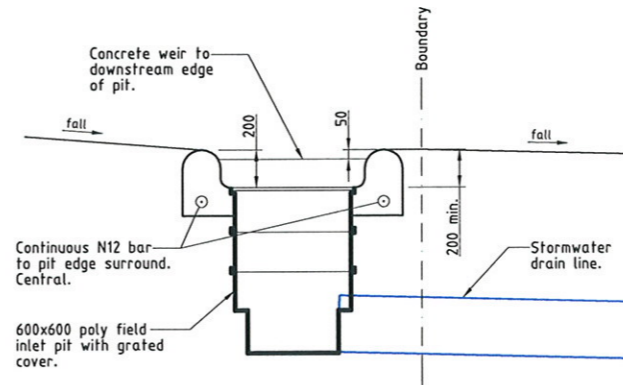

600x600 POLY FIELD INLET PIT (TYPICAL)
Scale 'C'

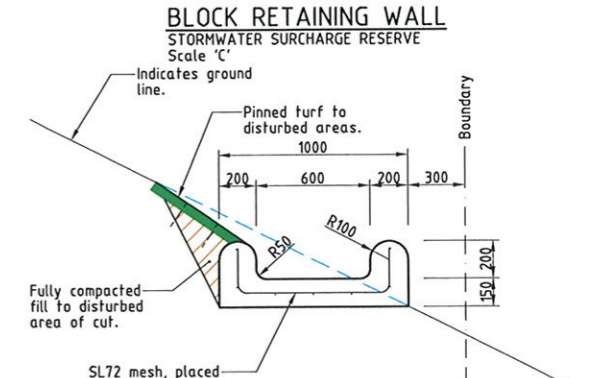

**BLOCK RETAINING WALL
STORMWATER SURCHARGE RESERVE**
Scale 'C'

AS CONSTRUCTED

Northern Consulting Engineers hereby certify that the works detailed on this drawing have been constructed to the dimensions and levels detailed.

Derek Robert Conley Saw Date: 10-1-10

AS CONSTRUCTED

I John James Rowlands of ROWLANDS SURVEYS Pty. Ltd. hereby certify that this drawing accurately describes and records the nature and the location of the works depicted hereon as they have been constructed for the purposes of the development.

John James Rowlands Director/Registered Surveyor Date: 12-01-10

REAL PROPERTY DESCRIPTION

Lot 501 & 502 on SP 162413
Parish of BOHLE
County of ELPHINSTONE
Bilbao Place - Bushland Beach

In Association with:-

ROWLANDS SURVEYS PTY LTD
22 GORDEN STREET
CARBUTT. 4814
Ph. (07)47755077

SUNLAND GROUP

LEVEL DATUM A.H.D.
Horizontal Datum GDA' 94 Zone 55
Refer P.M. 138403 RL. 8.545
Bolt & washer in manhole top.
LYNWOOD AVENUE

Scale 'A' 0 2.5 5 7.5 10m
Scale 'B' 0 0.5 1 1.5 2m
Scale 'C' 0 200 400 600 800
Scale 'D' 0 100 200 300 400

THE ORIGINAL OF THIS DOCUMENT IS COMPLETED TO THE SCALE NOTED. AS REPRODUCTION CAN DISTORT SIZE & SHAPE USE ONLY THE DIMENSIONS PROVIDED ON ARCHITECTURAL &/OR ENGINEERING DRAWINGS. VERIFY DIMENSIONS ON SITE BEFORE CONSTRUCTION.

* - Indicates As Constructed information.
All work is carried out in accordance with the former THURINGOWA CITY COUNCIL standard details.

NORTHERN CONSULTING
engineers
Civil & Structural Engineers
50 Punari Street, Curralong 4812
Phone: 07 4725 5550 Fax: 07 4725 5850
Email: mail@nceng.com.au
Milton Messer & Associates Pty. Ltd.
ACN 100 817 356

Issue	Description	Date
B	AMENDED TO AS CONSTRUCTED.	11/01/2010
A	ISSUED FOR CONSTRUCTION.	16/07/2008
P2	PRELIMINARY - NOT FOR CONSTRUCTION - AMENDED TO COUNCIL REQUIREMENTS.	13/12/2007
P1	PRELIMINARY - NOT FOR CONSTRUCTION - ISSUED FOR OPERATIONAL WORKS APPROVAL.	12/10/2007

Drawn: CN
Date: 12/10/2007
Checked: [Signature]
Approved: [Signature]
COPYRIGHT ©

In Association with:
SUNLAND GROUP LIMITED
STAGE 84, 41 TRADITIONAL
RESIDENTIAL LOT SUBDIVISION
BILBAO PLACE
BUSHLAND BEACH

CONSTRUCTION DETAILS
Drawing Number: SUN84/13
Issue: B