

SAWN JOINT (SWJ)
Scale 'B'

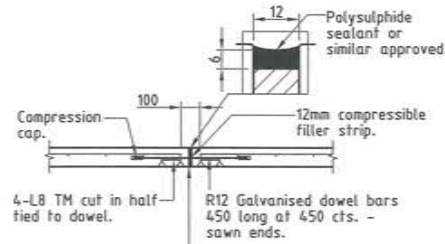

ROLLED UP BARRIER KERB
Scale 'C'

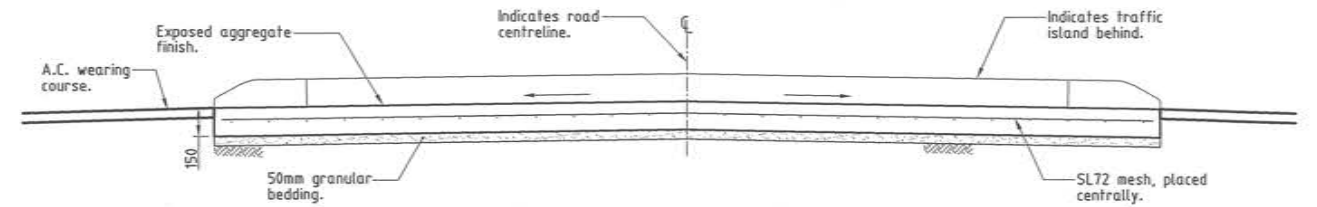

CONCRETE PEDESTRIAN REFUGE (TYPICAL)
Scale 'B'

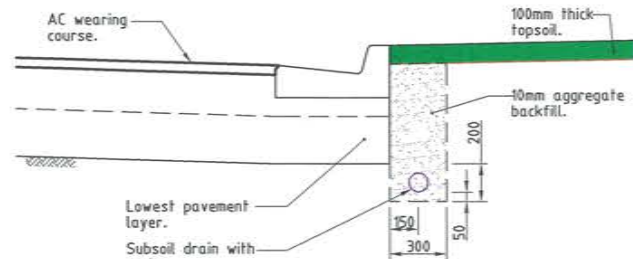

TYPICAL SUBSOIL DRAIN INSTALLATION
Scale 'B'

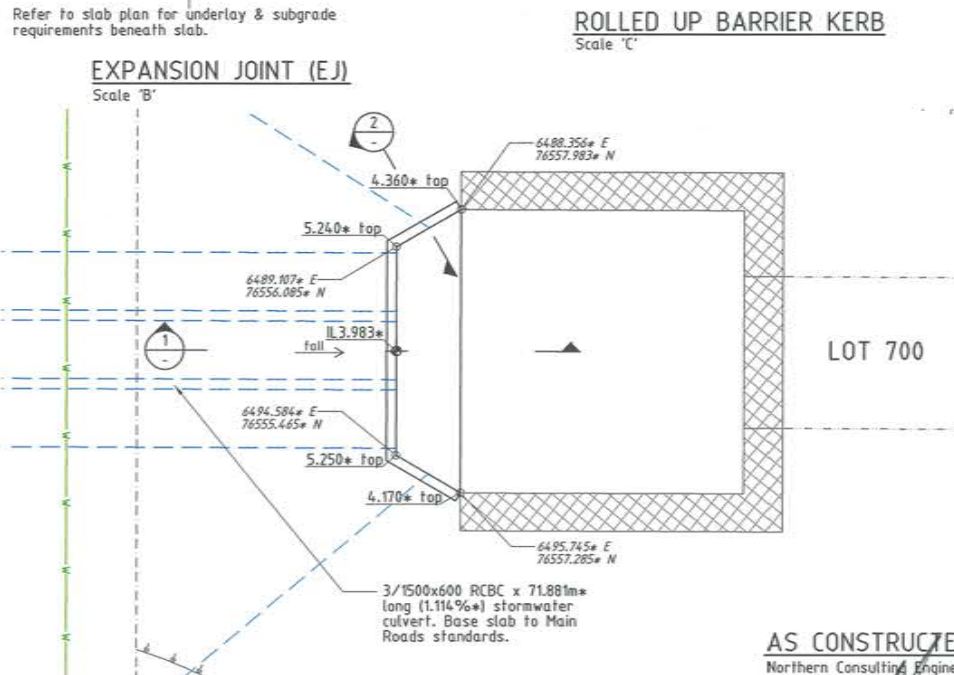

SALONIKA CIRCUIT CULVERT PLAN
Scale 'B'

AS CONSTRUCTED
Northern Consulting Engineers hereby certify that the works detailed on this drawing have been constructed to the dimensions and levels detailed.
Derek Robert Conley Saw Date: 1-6-15

AS CONSTRUCTED
Rowlands Surveys Pty Ltd (ACN 010 025 260) hereby certify that the works detailed on this drawing, denoted *, have been constructed to the dimensions and levels shown.
Laurence John Nolan Director/Registered Surveyor Date: 1/6/15

ACCEPTED AS CONSTRUCTED

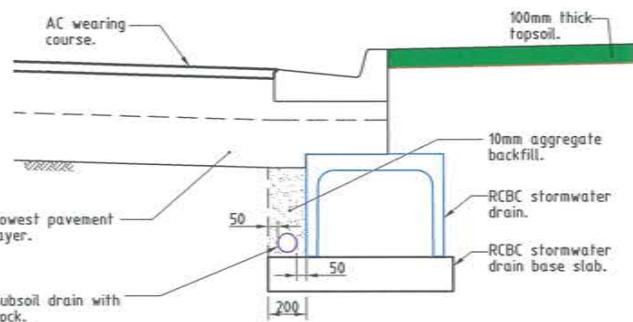

ALTERNATE SUBSOIL DRAIN INSTALLATION
Scale 'B'

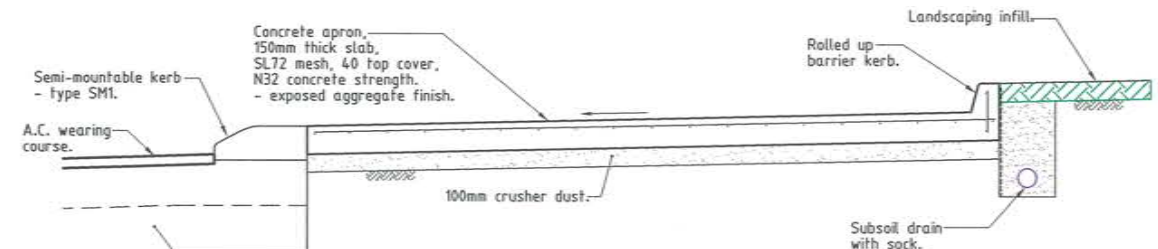

ROUNDABOUT APRON (TYPICAL)
Scale 'B'

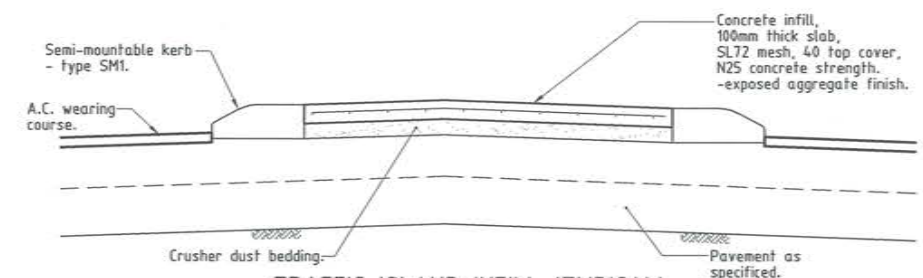

TRAFFIC ISLAND INFILL (TYPICAL)
Scale 'B'

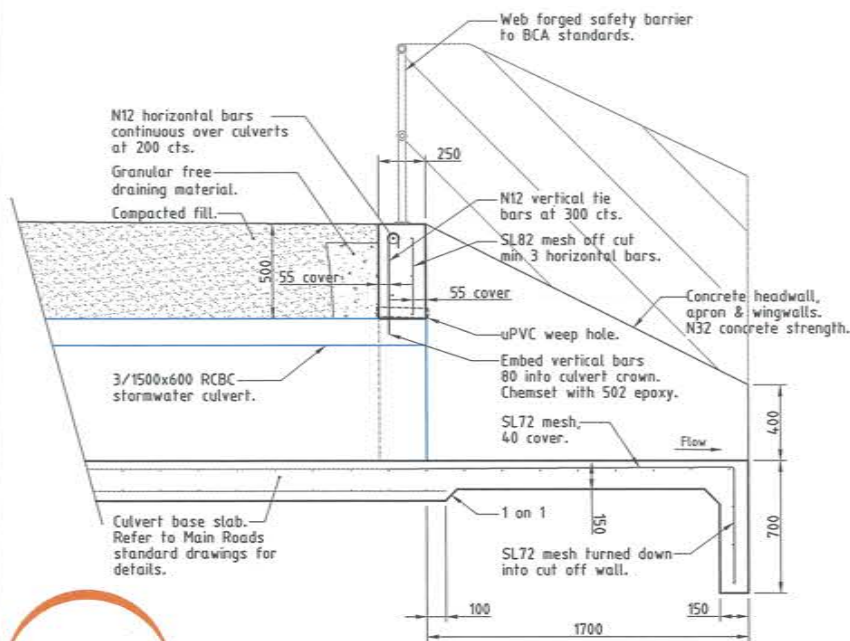

SECTION 1
Scale 'B'

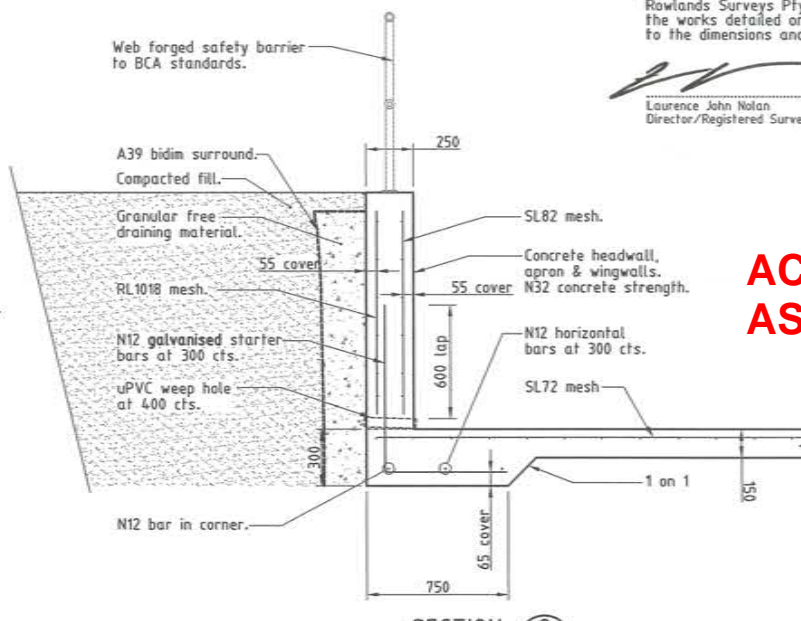

SECTION 2
Scale 'B'

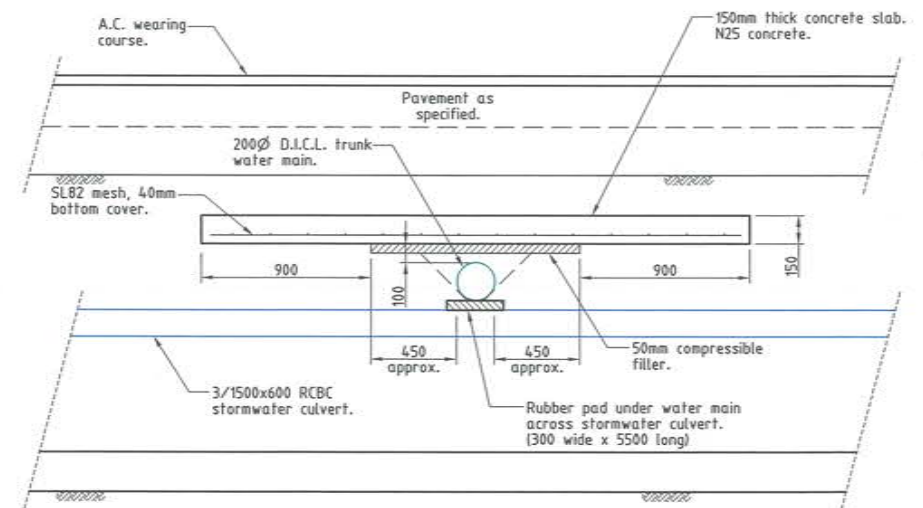

SECTION 1/18
Scale 'B'

All work has been carried out in accordance with LOCAL AUTHORITIES standard details.



Civil & Structural Engineers
50 Punari Street, Currajong 4812
Phone: [07] 4725 5550 Fax: [07] 4725 5850
Email: mail@nceng.com.au
Milton Messer & Associates Pty. Ltd.
ACN 100 817 356



REAL PROPERTY DESCRIPTION
Lot 902 on SP256043
Parish of BOHLE
County of ELPHINSTONE
Lionel Turner Drive - Bushland Beach

SECTION 1
Scale 'B'

LEVEL DATUM A.H.D.
Horizontal Datum GDA 94 Zone 55
Refer P.24, 1744.39 RL, 4.820
Bolt & washer in kerb.
Cnr HILLOCK CR. & GLENDOWER ST.
BASE SURVEY
Rowlands Surveys (43074/02)
TRUNCATED COORDINATES
E 0.000, N 0.000
EQUIVALENT TO
E 466000, N 7800000

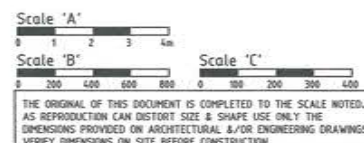

THE ORIGINAL OF THIS DOCUMENT IS COMPLETED TO THE SCALE NOTED. AS REPRODUCTION CAN DISTORT SIZE & SHAPE USE ONLY THE DIMENSIONS PROVIDED ON ARCHITECTURAL &/OR ENGINEERING DRAWINGS. VERIFY DIMENSIONS ON SITE BEFORE CONSTRUCTION.

Issue	Description	Date
B	AMENDED TO AS CONSTRUCTED.	29/05/2015
A	ISSUED FOR CONSTRUCTION - RESPONSE TO COUNCIL INFORMATION REQUEST.	02/12/2014
P1	PRELIMINARY - NOT FOR CONSTRUCTION - ISSUED FOR OPERATIONAL WORKS APPROVAL ONLY.	05/09/2014

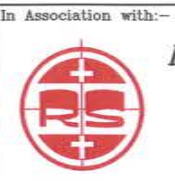

ROWLANDS SURVEYS PTY LTD
22 GORDEN STREET
GARBUTT. 4814
Ph. (07)47755077

Drawn	In Association With	CONSTRUCTION DETAILS
HAB	SUNLAND GROUP LIMITED	
Date	05/09/2014	
Checked	HAB	
Approved	HAB	
COPYRIGHT ©	ROAD EXTENSION LIONEL TURNER DRIVE BUSHLAND BEACH	Drawing Number SUNG0002/16
		Issue B